

**LOS ANGELES COUNTY**  
**DEPARTMENT OF PUBLIC WORKS**  
**BENCH MARK LIST**



**LA CANADA QUAD**  
**PASADENA QUAD**

**1995 ADJUSTMENT**

**NAVD 88 DATUM**  
**METRIC**



ABBREVIATIONS USED IN BENCH MARK LISTINGS

ABUT -----	Abutment	ECR -----	End of Curb Return
ALG -----	Along	EC -----	End of Curve
ANG PT -----	Angle Point	ENT -----	Entrance
B/W -----	Back of Walk	FL -----	Floor
BCR -----	Beginning of Curb Return	FTG -----	Footing
BC -----	Beginning of Curve	FRWY -----	Freeway
BLDG -----	Building	F/W -----	Front of Walk
BM -----	Bench Mark	GAR -----	Garage
BT SPK -----	Boat or Bolt Spike	HDWL -----	Headwall
BR CAP -----	Brass or Bronze Cap	HSE -----	House
C B -----	Catch Basin	HWY -----	Highway
CTR -----	Center	INT -----	Intersection
C/L -----	Center Line	IP -----	Iron Pipe
C/L INT -----	Center Line Intersection	LT -----	Left
C/L PROD -----	Center Line Produced	LACE -----	L.A. City Engineer
CONC -----	Concrete	LACS -----	L.A. Co. Engineer
COR -----	Corner	LAFC -----	L.A. Co. Flood Control
COE -----	Corps of Engineers	L&BN -----	Lead and Bench Nail
CULV -----	Culvert	L&BR -----	Lead and Brad
CYN -----	Canyon	L&N -----	Lead and Nail
CB -----	Curb	L&SPK -----	Lead and Spike
CS MON -----	Co. Eng. Monument	L&T -----	Lead and Tack
CT SPK -----	Cut Spike	MCR -----	Middle of Curb Return
DPW -----	Dept. of Public Works	MKD -----	Marked
DR -----	Drive or Driveway	MC -----	Middle of Curve
E/O -----	East of	MON -----	Monument

ABBREVIATIONS USED IN BENCH MARKS (CON'T)

N/O ----- North of  
NR ----- Near  
OPP ----- Opposite  
PI ----- Point of Intersection  
PK&W ----- PK Nail and Washer  
P/L ----- Property Line  
POST ----- Point of Semi-Tangent  
PP ----- Power Pole  
PVMT ----- Pavement  
PROD ----- Produced  
RD ----- Road  
RDBM ----- Road Dept. Bench Mark  
RDBM TAG ----- Road Dept. Bench Mark Tag  
RR ----- Railroad  
RT ----- Right  
R/W ----- Right of Way  
SDMH ----- Storm Drain Manhole  
SMH ----- Sewer Manhole  
SPK ----- Spike  
ST&W ----- Spike Tin and Washer  
S/O ----- South of  
TP ----- Telephone Pole  
USC&GS ----- U.S. Coast and Geodetic Survey  
USGS ----- U.S. Geological Survey  
WK ----- Walk  
W/O ----- West of



# PASADENA

Q

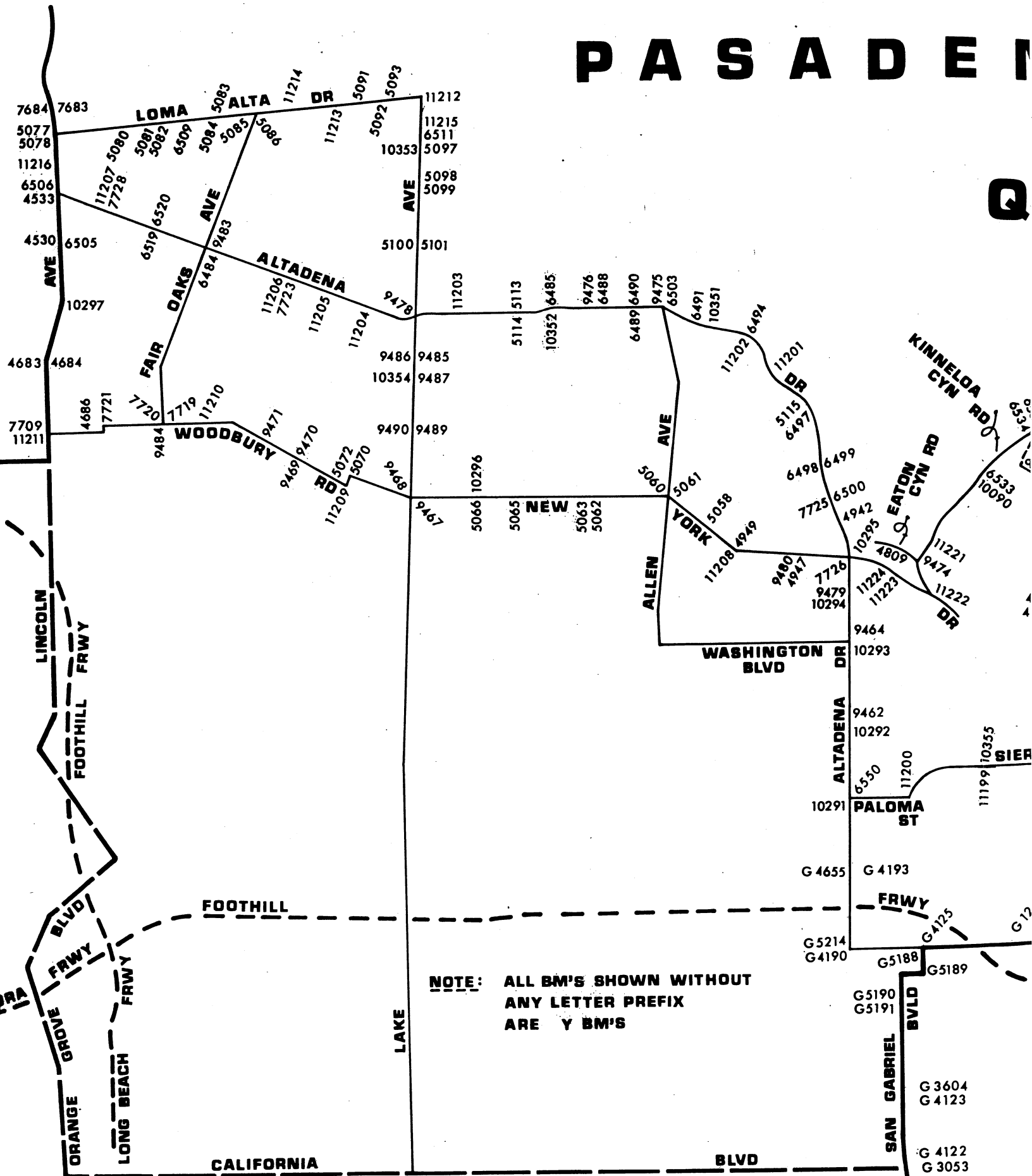

**NOTE: ALL BM'S SHOWN WITHOUT ANY LETTER PREFIX ARE Y BM'S**

7684 7683  
5077 5078  
11216  
6506 4533  
4530 6505  
10297  
4683 4684  
7709 11211  
4686 7721  
7720 7719 11210  
9484  
11207 5080 7728  
5081 5082 6509  
5084 5085 5086  
LOMA ALTA DR 11214  
5091 5092 5093  
11212  
11215 6511 5097  
10353  
5098 5099  
AVE  
5100 5101  
9478  
11203  
11205 11204  
9476 6488 6489 6490 9475 6503  
5114 5113 10352 6485  
9476 6488  
6489 6490  
6491 10351  
11202 6494  
11201  
5115 6497  
6498 6499  
7725 6500  
4942  
10295  
10296  
11208 4949  
5060 5061 5058  
11208 4949  
9480 4947 7726 9479 10294  
11224 11223  
4809  
11221 9474 11222  
DR  
9464 10293  
WASHINGTON BLVD  
ALTADENA DR  
9462 10292  
6550 11200  
10291 PALOMA ST  
11199 10355  
G 4655 G 4193  
FRWY  
G 5214 G 4190  
G 5188 G 5189  
G 5190 G 5191  
SAN GABRIEL BLVD  
G 3604 G 4123  
G 4122 G 3053

# QUAD

VISTA DEL VALLE RD

ANGELES CREST HWY

WILADONDA DR

LYNNHAVEN LANE

OAKWOOD AVE

10303  
10304

11229

9317  
4509

FOOTHILL

10303  
4310

10302  
11228

11227  
11226

BLVD

4515  
4516

11225

FRANK GROVE DR

6615 11256

CHEVY CHASE

11254 11255

6611 6612

6609

7684  
7683

ALTADENA DR

5078  
5077  
11216  
6507

6506  
4533

AVE

4537 9548

4539 11245

4524

VENTURA ST

4526  
4527

6505  
4530

10297

# QUAD

7718  
7717

AVE

11250 11251

4669 4670

VISTA DEL VALLE RD

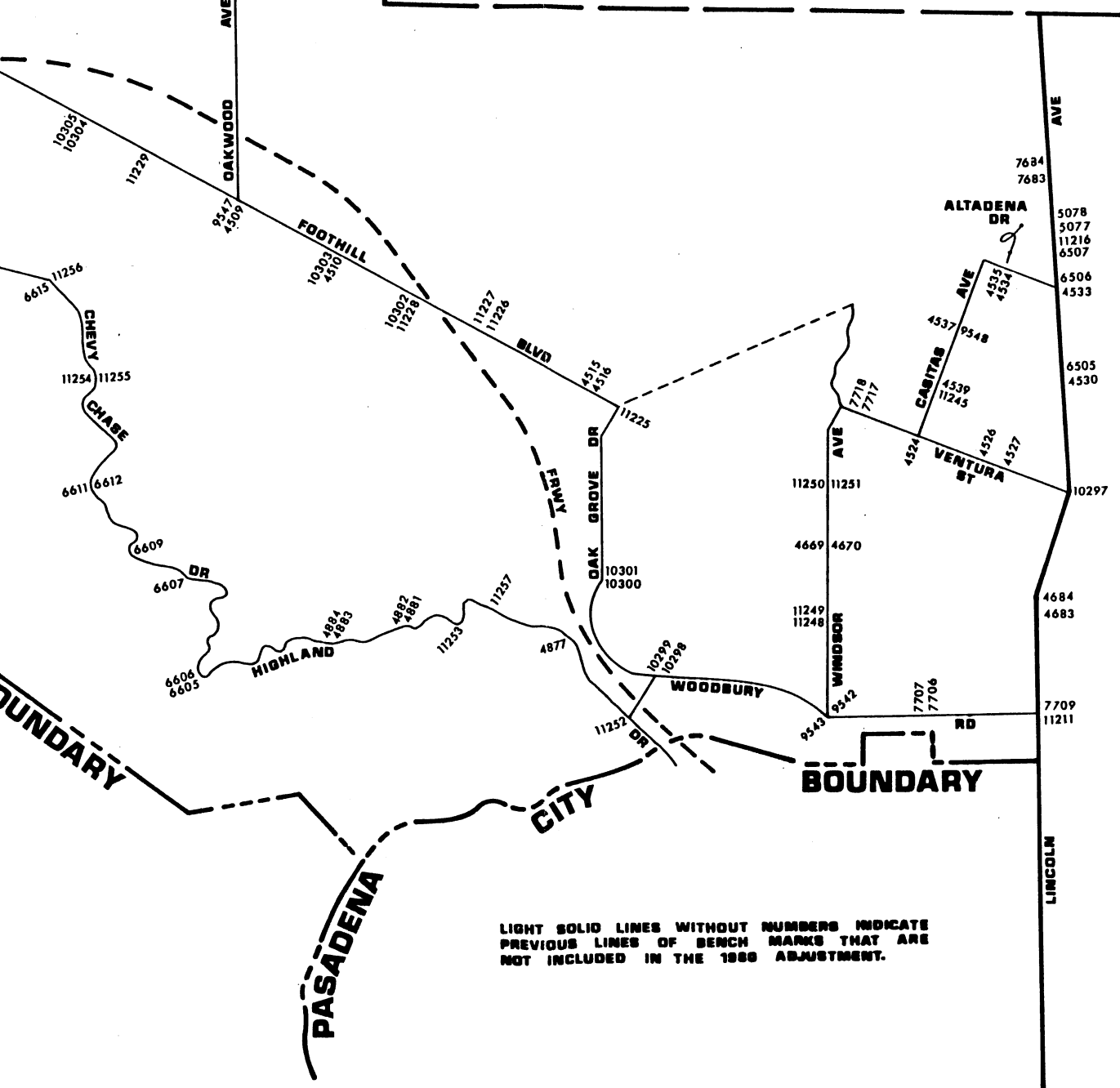
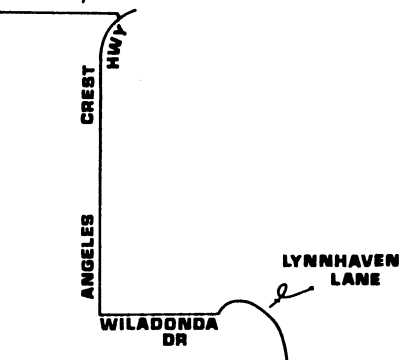

PASADENA GUAD PASADENA

LIGHT SOLID LINES WITHOUT NUMBERS INDICATE PREVIOUS LINES OF BENCH MARKS THAT ARE NOT INCLUDED IN THE 1980 ADJUSTMENT.



# LA CANADA QUAI

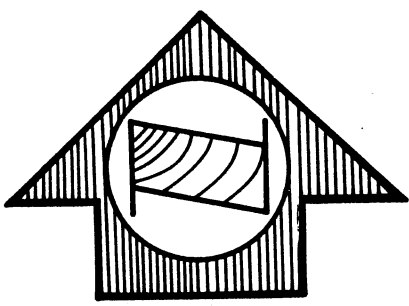
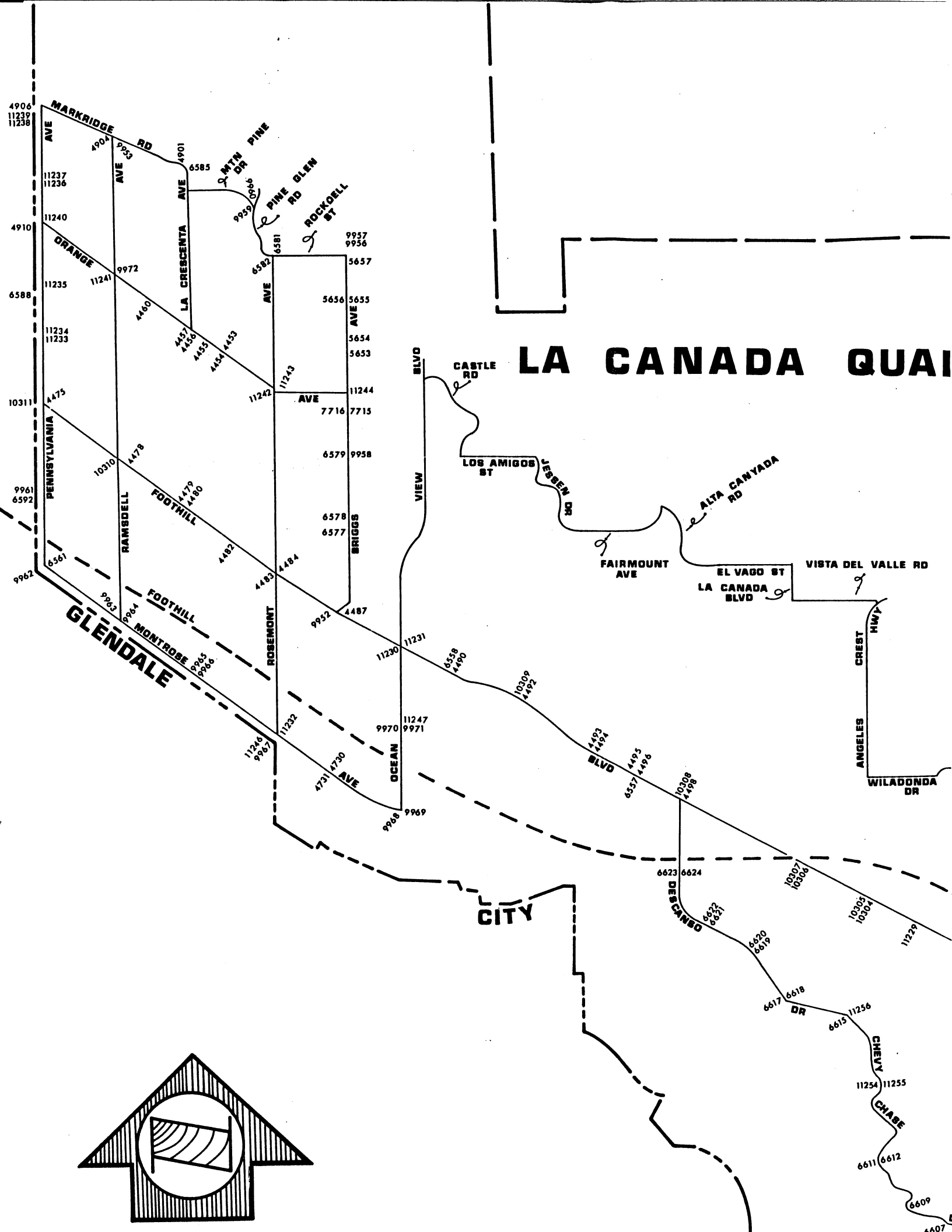

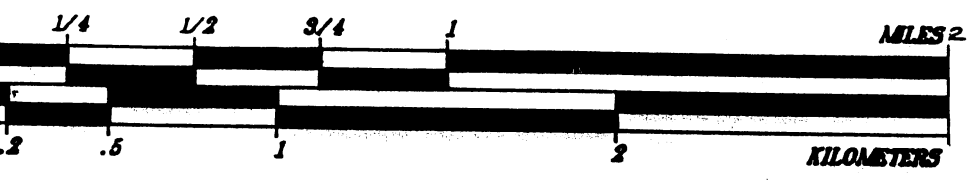
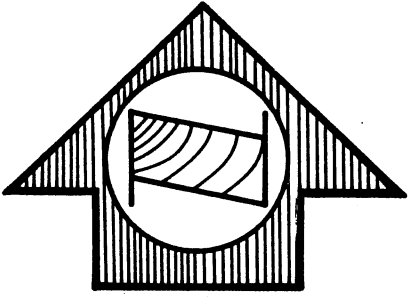
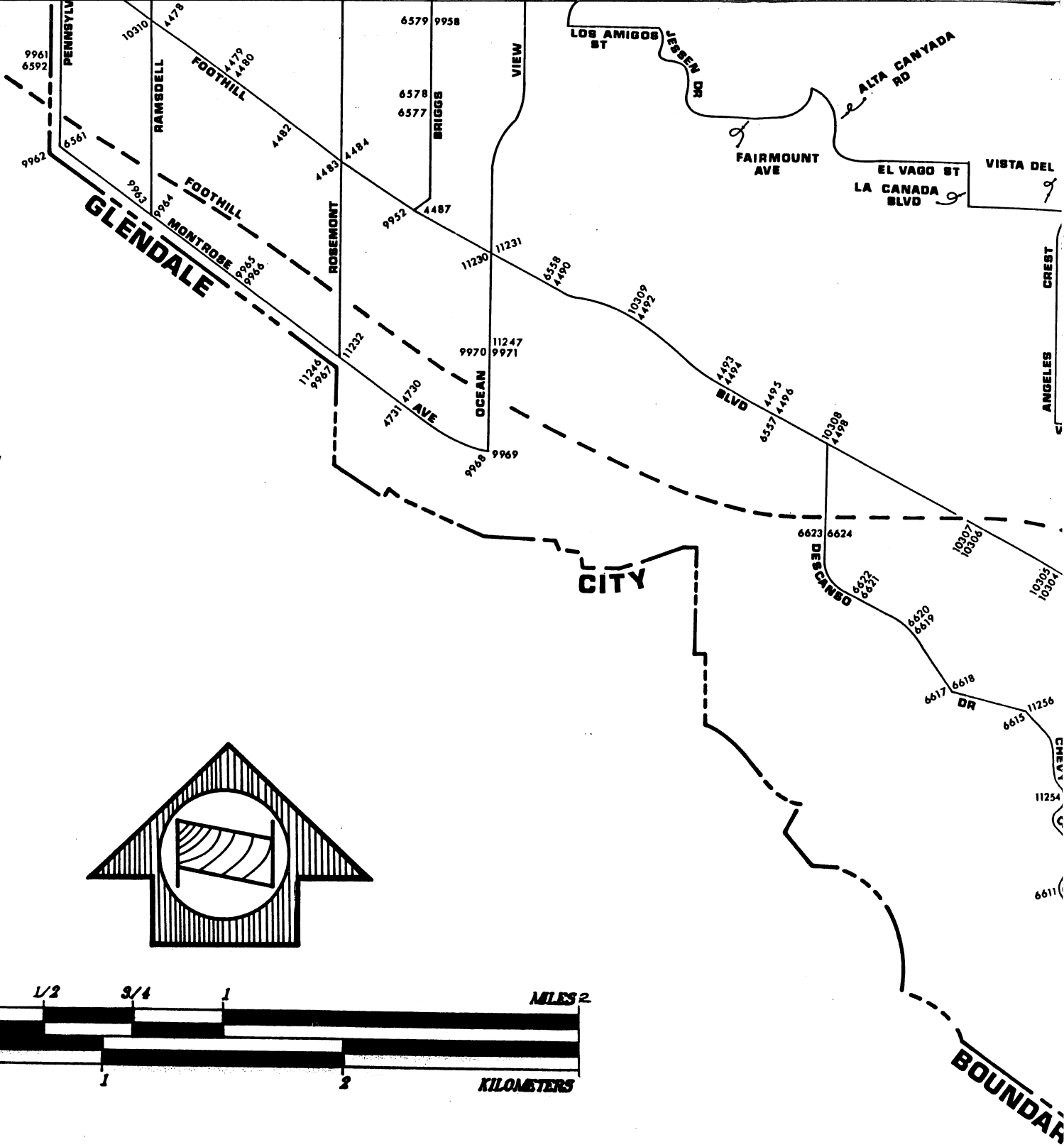

AD-YEAR	ELEV METER/FOOT	DESCRIPTION (INCLUDE QUAD AND YEAR IN DESCRIPTION)	BM NUMBER
BASELINE (1995)	0218.435 0716.649	L&BN E CB 9M N/O BCR @ NE COR FOOTHILL BLVD & SIERRA MADRE VILLA 30.5M N & 8.5M E/O C/L INT	G 1247
BASELINE (1995)	0220.398 0723.089	RAMSET IN CB 300MM W/O BCR @ SE COR SANTA PAULA AVE & FOOTHILL BLVD 15.5M W & 9M N/O C/L INT	G 1249
BASELINE (1995)	0210.298 0689.953	L&BN IN S CB FOOTHILL BLVD 10.4M S/O C/L IN CTR OF C B @ BLDG #3600 161M W/O ROSEMEAD BLVD	G 1254
BASELINE (1995)	0203.945 0669.110	SPK&W IN N CB 300MM E/O BCR @ NE COR DEXTER AVE & FOOTHILL BLVD 15M E & 8.2M N/O C/L INT MKD BM	G 2494
BASELINE (1995)	0204.967 0672.463	L&BN E CB 300MM S/O BCR @ NE COR FOOTHILL BL N SERV RD & DEXTER AVE 7.6M & 6.4M E/O C/L INT	G 2495
BASELINE (1995)	0180.955 0593.683	CS BR MON IN WELL 300MM N/O C/L FOOTHILL BLVD & 21M E/O C/L BURNELL OAKS LN MKD (SIERRA MADRE G-6 1940 RE 2177)	G 2502
BASELINE (1995)	0202.261 0663.585	SPK IN E CB 2M S/O BCR @ SE COR CALIFORNIA BLVD & SAN GABRIEL BLVD 18M S & 8.2M E/O C/L INT	G 3053
BASELINE (1995)	0218.343 0716.347	CS MON IN WELL 300MM E/O E CF 15M N/O BCR @ NE COR FOOTHILL BLVD & SIERRA MADRE VILLA 36M N & 8.8M E/O C/L INT MKD (BM 10-9A RE 5869 1962)	G 3094
BASELINE (1995)	0200.150 0656.659	RDBM TAG N CB FOOTHILL BL 300MM E/O BCR SERVICE RD 8.2M N/O C/L & 23M E/O C/L DON ROBLES DR	G 3594
BASELINE (1995)	0212.468 0697.072	L&BN IN S END C B 1M N/O BCR @ NW COR DEL MAR BLVD & SAN GABRIEL BLVD 18M N & 9M W/O C/L INT	G 3604
PASADENA (1995)	0211.116 0692.636	PK&TAG E CB 1.2M E/O BCR @ NE COR BALDWIN AVE & HAMPTON RD 17M E & 5.5M N/O C/L INT MKD (BM)	G 4016
PASADENA (1995)	0211.578 0694.152	RDBM TAG IN E CB (SERV RD) S END C B 13.7M W & 9M N/O C/L INT BALDWIN AVE & HAMPTON RD	G 4017
PASADENA (1995)	0226.244 0742.269	RDBM TAG S CB 7M E/O BCR @ SE COR BALDWIN AVE & ORANGE GROVE AVE 19M E & 5.5M S/O C/L INT	G 4018
PASADENA (1995)	0227.244 0745.550	RDBM TAG W CB S END C B 300MM N/O BCR @ NW COR BALDWIN AVE & ORANGE GROVE AVE 11M N & 9M W/O C/L INT	G 4019
PASADENA (1995)	0234.757 0770.199	RDBM TAG IN E CB BALDWIN AVE 8M E/O C/L & 2.6M S/O C/L PROD W BONITA AVE	G 4020
PASADENA (1995)	0235.552 0772.807	RDBM TAG IN N CB 600MM W/O BCR @ NW COR BALDWIN AVE & W BONITA AVE 13M W & 5.5M N/O C/L INT	G 4021

JAD-YEAR	ELEV METER/FOOT	DESCRIPTION (INCLUDE QUAD AND YEAR IN DESCRIPTION)	BM NUMBER
PASADENA (1995)	0236.905 0777.246	RDBM TAG W CB @ C B 15.5M N BCR NE COR SIERRA MADRE BLVD & MT TRAIL AVE 28M N & 6M W/O C/L INT	G 4024
PASADENA (1995)	0234.006 0767.735	RDBM TAG IN E CB 14M S/O BCR @ SE COR SIERRA MADRE BLVD & MT TRAIL AVE 27M E & 6M E/O C/L INT	G 4025
PASADENA (1995)	0227.018 0744.808	RDBM TAG E CB NR C B 8M N/O BCR @ NE COR SIERRA MADRE BLVD & CANON AVE 19M N & 6M E/O C/L INT	G 4027
PASADENA (1995)	0204.009 0669.320	RDBM TAG IN W CB 2.4M N/O BCR @ NW COR SIERRA MADRE BLVD & CLARIDGE ST 17M N & 6M W/O C/L INT	G 4028
PASADENA (1995)	0203.803 0668.644	RDBM TAG E CB RET 600MM S/O BCR @ NE COR SIERRA MADRE BLVD & CLARIDGE ST 13M N & 6M E/O C/L INT	G 4029
BASELINE (1995)	0199.562 0654.730	CS MON IN WELL 250MM DN @ APPROX C/L INT SANTA ANITA AVE (E BBL) & SIERRA MADRE BLVD MKD I-5	G 4031
BASELINE (1995)	0179.746 0589.717	CS MON IN WELL 300MM DN 3M E & 1M S/O C/L INT SANTA ANITA AVE (E BBL) & ORANGE GROVE AVE MKD (I-6A 1945)	G 4032
BASELINE (1995)	0202.392 0664.014	RDBM TAG IN S END C B 2M N/O BCR @ NE COR SAN GABRIEL BLVD & CALIFORNIA BLVD 16M N & 8.2M E/O C/L INT	G 4122
BASELINE (1995)	0212.336 0696.639	CSBM MON IN N END C B @ NE COR SAN GABRIEL BLVD & DEL MAR BLVD 23M N & 9.1M E/O C/L INT MKD (BM 10-7A 1971 RE 5869)	G 4123
BASELINE (1995)	0226.856 0744.277	CSBM MON IN N WALL C B 4.3M N/O BCR @ NW COR FOOTHILL BLVD & DAISY AVE 20M N & 5.8M W/O C/L INT MKD (BM 10-8B 1971 RE 5869)	G 4125
BASELINE (1995)	0214.957 0705.238	RAMSET IN N CB 300MM W/O BCR @ NW COR FOOTHILL BLVD & HALSTEAD ST 19M W & 10M N/O C/L INT	G 4126
BASELINE (1995)	0214.557 0703.926	RDBM TAG N CB 300MM E/O BCR @ NE COR FOOTHILL BLVD & HALSTEAD ST 19M E & 10M N/O C/L INT	G 4127
BASELINE (1995)	0211.561 0694.096	RDBM TAG S CB 2M E/O BCR @ SW COR ROSEMEAD BL & FOOTHILL BL 21.6M W & 12.2M S/O C/L INT	G 4128
BASELINE (1995)	0212.047 0695.691	CSBM MON 300MM N/O N CF 1.2M E/O BCR @ NE COR ROSEMEAD BLVD & FOOTHILL BLVD 21M E & 15M N/O C/L INT MKD (BM 10-9C 1971 RE 5869)	G 4129
BASELINE (1995)	0207.654 0681.278	CSBM MON IN N END C B 3.7M N/O BCR @ NW COR FOOTHILL BLVD & MICHILLINDA AVE 25M N & 12.5M W/O C/L INT MKD (BM 10-10A 1971 RE 5869)	G 4130

JAD-YEAR	ELEV METER/FOOT	D E S C R I P T I O N (INCLUDE QUAD AND YEAR IN DESCRIPTION)	BM NUMBER
BASELINE (1995)	0206.545 0677.640	RDBM TAG S CB 300MM E/O BCR @ SE COR FOOTHILL BLVD & MICHILLINDA AVE 25M E & 12M S/O C/L INT	G 4131
BASELINE (1995)	0200.169 0656.721	CSBM MON IN W WALL C B 2M E/O BCR OF SERV RD 9.4M N/O C/L FOOTHILL BLVD 23M E/O C/L DON ROBLES DR MKD ( BM 10-11A 1971 RE 5869)	G 4132
BASELINE (1995)	0168.362 0552.368	FC BR DISC IN W WINGWALL FC CHANNEL 11.3M N/O C/L FOOTHILL BLVD & 116M E/O C/L RANCHO RD MKD (BM 062-31125 1967)	G 4133
PASADENA (1995)	0266.434 0874.126	RDBM TAG S CB 300MM W/O BCR @ SW COR LIMA ST & SIERRA MADRA BLVD 10M W & 8.5M S/O C/L INT	G 4182
PASADENA (1995)	0276.634 0907.590	CSBM DISK 300MM E/O E CF S END C B 5.5M N/O BCR NE COR SIERRA MADRE BL & MICHILLINDA AVE 27M N & 8M E/O C/L INT MKD (BM 25-38 1975 RE 70781)	G 4183
PASADENA (1995)	0276.543 0907.291	RAMSET N CB 300MM W/O BCR @ NW COR MICHILLINDA AVE & SIERRA MADRE BL 17M W & 23M N/O C/L INT	G 4184
BASELINE (1995)	0180.632 0592.623	L&BR IN CTR CB RET @ SW COR SANTA ANITA AVE & ORANGE GROVE AVE 16M W & 7.6M S/O C/L INT	G 4187
BASELINE (1995)	0200.793 0658.768	L AFC TAG IN CTR CB RET @ NE COR SANTA ANITA AVE & SIERRA MADRE BLVD 13.4M E & 10M N/O C/L INT	G 4188
PASADENA (1995)	0232.185 0761.760	RDBM TAG S CB 300MM E/O BCR @ SE COR FOOTHILL BLVD & ALTADENA DR 14M E & 9.8M S/O C/L INT	G 4190
PASADENA (1995)	0243.288 0798.187	RDBM TAG IN E CB 300MM S/O BCR @ SE COR VILLA ST & ALTADENA DR 17M S & 12.2M E/O C/L INT	G 4193
BASELINE (1995)	0372.991 1223.721	CS MON IN WELL 250MM DN @ OR NR C/L INT LINCOLN AVE & MENDOCINO ST MKD (TRAV STA ALTADENA F 1)	NY 4530
BASELINE (1995)	0383.783 1259.128	RD HD SPK S CB 600MM E/O BCR @ SE COR LINCOLN AVE & ALTADENA DR 29M E & 8.2M S/O C/L INT	NY 4533
BASELINE (1995)	0194.696 0638.765	RDBM TAG IN SE COR EDISON BOX 600MM W/O CF 2M N/O BCR @ NW COR FOOTHILL BLVD & BALDWIN AVE 20M N & 10M W/O C/L INT	G 4545
BASELINE (1995)	0166.715 0546.964	DPW BM TAG IN S END C B 6M N/O BCR @ NE COR FOOTHILL BLVD & SANTA ANITA AVE 23M N & 11.6M E/O C/L INT	G 4574
PASADENA (1995)	0244.070 0800.753	CITY ENGR TAG RCE #11257 IN N CB 4.5M W/O BCR @ NW COR ALTADENA DR & VILLA ST 24.4M W & 9M N/O C/L INT	G 4655

JAD-YEAR	ELEV METER/FOOT	DESCRIPTION (INCLUDE QUAD AND YEAR IN DESCRIPTION)	BM NUMBER
PASADENA (1995)	0226.936 0744.539	DPW BM TAG N CB 6.4M W/O BCR @ NW COR SIERRA MADRE BLVD & CANON AVE 17M W & 6.7M N/O C/L INT	G 4730
PASADENA (1995)	0253.888 0832.964	DPW BM TAG W CB 300MM N/O BCR @ NW COR SIERRA MADRE BL & BALDWIN AVE 16.5M N & 8.5M W C/L INT	G 4731
PASADENA (1995)	0266.960 0875.851	DPW BM TAG N CB 300MM W/O BCR @ NW COR SIERRA MADRE BLVD & LIMA ST 9.4M W & 8.5M N/O C/L INT	G 4732
PASADENA (1995)	0276.835 0908.249	DPW BM TAG W CB 1.5M N/O BCR @ NW COR SIERRA MADRE BLVD & HASTINGS RANCH DR 17.4M N & 7.3M W/O C/L INT	G 4733
PASADENA (1995)	0269.557 0884.372	DPW BM TAG IN W CB 1M N/O BCR @ NW COR SIERRA MADRE BLVD (N BBL) & RIVERA DR 14M N & 5.8M W/O C/L INT	G 4734
BASELINE (1995)	0180.588 0592.479	COE BR MON IN E CB SANTA ANITA AVE 12M N/O C/L PROD ORANGE AVE MKD (BM W-100 1962)	G 5182
BASELINE (1995)	0172.483 0565.888	L&BR INN CB 1M W/O BCR @ NW COR SANTA ANITA AVE & WOODLAND LN 23M W & 8.5M N/O C/L INT	G 5183
BASELINE (1995)	0166.743 0547.056	L&BR IN N CB @ BCR NW COR SANTA ANITA AVE & FOOTHILL BLVD 17.4M W & 9.4M N/O C/L INT	G 5184
BASELINE (1995)	0170.918 0560.753	L&BR IN S CB W END C B 2M W BCR @ SW COR RANCHO RD & FOOTHILL BLVD 17.4M W & 8.5M S/O C/L INT	G 5185
BASELINE (1995)	0189.636 0622.164	L&BN IN N CB FOOTHILL BLVD 9.8M N/O C/L & 32M E/O C/L PROD BALDWIN AVE (FROM THE S)	G 5186
BASELINE (1995)	0194.388 0637.755	DPW BM TAG IN S CB (SERV RD) 2M E/O BCR 15M N/O FOOTHILL BLVD & 15M E/O C/L BALDWIN AVE S	G 5187
BASELINE (1995)	0226.297 0742.443	RAMSET IN N CB RET 300MM W/O BCR @ NE COR DAISY AVE & FOOTHILL BLVD 12M E & 10M N/O C/L INT	G 5188
BASELINE (1995)	0222.651 0730.481	CITY PASADENA L&TAG IN SW CB RET 1.5M N/O BCR 9M S & 6.4M W/O C/L INT WALNUT ST & DAISY AVE	G 5189
BASELINE (1995)	0220.190 0722.407	DPW BM TAG S CB 2M W/O BCR @ SW COR COLORADO BLVD & SAN GABRIEL BLVD 18M W & 11M S/O C/L INT	G 5190
BASELINE (1995)	0219.680 0720.733	DPW BM TAG IN E CB 1M S/O BCR @ SE COR COLORADO BLVD & SAN GABRIEL BLVD 20M S & 9M E/O C/L INT	G 5191
PASADENA (1995)	0251.883 0826.386	DPW BM TAG IN S CB 1M E/O BCR @ SE COR SIERRA MADRE BL & BALDWIN AVE 16M E & 7.6M S/O C/L INT	G 5212

JAD-YEAR	ELEV METER/FOOT	DESCRIPTION (INCLUDE QUAD AND YEAR IN DESCRIPTION)	BM NUMBER
LA CANADA (1995)	0540.615 1773.668	L&T IN S CB ORANGE AVE 7M S/O C/L ON C/L PROD EL ADOBE LN	Y 4453
LA CANADA (1995)	0541.607 1776.922	L&T IN W CB RET ORANGE AVE 300MM S/O BCR 7.3M W/O C/L & 15M N/O C/L EL ADOBE LN MKD (BM)	Y 4454
LA CANADA (1995)	0541.932 1777.989	L&T IN N CB ORANGE AVE 300MM W/O C B 6M N/O C/L 6.7M W FC CHANNEL & 122M E C/L LA CRESCENTA AVE	Y 4455
LA CANADA (1995)	0541.776 1777.477	L&T S CB ORANGE AVE 300MM W/O C B 6M S C/L 4.6M W/O FC CHANNEL & 122M E/O C/L LA CRESCENTA AVE	Y 4456
LA CANADA (1995)	0543.116 1781.873	L&T NR CTR CB RET @ SE COR LA CRESCENDA AVE & ORANGE AVE 10M S & 9M E/O C/L INT	Y 4457
LA CANADA (1995)	0544.795 1787.382	CT SPK IN N CB ORANGE AVE @ BCR 6M N/O C/L & 6.7M E/O C/L LA CRESCENTA AVE	Y 4458
LA CANADA (1995)	0555.426 1822.260	L&T NR CTR CB RET @ SW COR 12.8M S/O C/L ORANGE AVE & 8.5M W/O C/L GLENWOOD AVE MKD (BM)	Y 4460
LA CANADA (1995)	0480.768 1577.320	L&BR IN N CB 9M E/O BCR @ NE COR FOOTHILL BLVD & PENNSYLVANIA AVE 12.2M N & 17M E/O C/L INT	Y 4475
LA CANADA (1995)	0478.696 1570.522	WIRE SPK NR C/L CONC HDWL DRAINAGE CHANNEL 1.5M N/O N CF FOOTHILL BLVD 14M N/O C/L & 123M E/O C/L RAMSDELL AVE (W/O BLDG #2933)	Y 4478
LA CANADA (1995)	0477.967 1568.130	CUT SPK IN W CB @ BCR NW COR FOOTHILL BLVD & LA CRESCENTA AVE 21M N & 7M W/O C/L INT (IN C B)	Y 4479
LA CANADA (1995)	0477.379 1566.201	ST CAL BR CAP IN N CB @ BCR NE COR FOOTHILL BLVD & LA CRESCENTA AVE 12M N & 13M E/O C/L INT MKD (DIV HWYS)	Y 4480
LA CANADA (1995)	0476.219 1562.395	L&BR IN N CB 4.6M E/O BCR @ NE COR FOOTHILL BLVD & RAYMOND AVE 12.2M N & 15M E/O C/L INT	Y 4482
LA CANADA (1995)	0472.761 1551.050	ST CAL BR CAP IN N CB @ BCR NW COR FOOTHILL BLVD & ROSEMONT AVE 12.2M N & 25M W/O C/L INT	Y 4483
LA CANADA (1995)	0471.843 1548.038	L&BN IN N CB 9M E BCR @ NE COR FOOTHILL BLVD & ROSEMONT AVE 12M N & 12.2M E/O C/L INT	Y 4484
LA CANADA (1995)	0466.563 1530.715	RAM SET IN W END HDWL 600MM E BCR 4.5M N/O N CF @ NE COR FOOTHILL BL & BRIGGS AVE 17M N & 17M E/O C/L INT	Y 4487
LA CANADA (1995)	0457.648 1501.467	ST CAL BR CAP N CB RET 300MM W/O BCR @ NE COR FOOTHILL BL & CASTLE RD 12M N & 4.6M E C/L INT	Y 4490

AD-YEAR	ELEV METER/FOOT	DESCRIPTION (INCLUDE QUAD AND YEAR IN DESCRIPTION)	BM NUMBER
LA CANADA (1995)	0465.025 1525.670	CS BR CAP FL 300MM E/O E CF 1.5M S/O BCR @ NE COR FOOTHILL BL & LITTLETON PL 21M N & 5.5M E/O C/L INT MKD (BM 47-1C 1955 RE 63)	Y 4492
LA CANADA (1995)	0457.925 1502.376	L&BR IN S CB FOOTHILL BLVD 12.2M S/O C/L & 15M W/O C/L PROD PALM DR	Y 4493
LA CANADA (1995)	0456.802 1498.691	L&BN IN S CB FOOTHILL BLVD 12.2M S/O C/L & 4.6M E/O C/L PROD PALM DR	Y 4494
LA CANADA (1995)	0444.148 1457.176	L&BN IN S CB 1.5M E/O BCR @ SW COR FOOTHILL BL & EL CAMINO CORTO 12.5M S & 7.3M W/O C/L INT	Y 4495
LA CANADA (1995)	0444.163 1457.225	L&BN IN S CB 600MM E/O BCR @ SE COR FOOTHILL BL & EL CAMINO CORTO 24M E & 12.2M S/O C/L INT	Y 4496
LA CANADA (1995)	0442.103 1450.466	RAMSET IN E CB 600MM N/O BCR @ NE COR FOOTHILL BL & ALTA CANYADA RD 17.4M N & 3.4M E/O C/L INT	Y 4498
LA CANADA (1995)	0374.778 1229.584	CS MON IN WELL 250MM DN 300MM S/O CF 9.8M E/O BCR @ SE COR FOOTHILL BLVD & OAKWOOD AVE 11M S & 23.5M E/O C/L INT MKD (BM-47-6)	Y 4509
LA CANADA (1995)	0364.227 1194.968	RAM SET IN S CB 1M W/O BCR @ SW COR FOOTHILL BLVD & GOULD AVE 12M S & 6.4M W/O C/L INT	Y 4510
LA CANADA (1995)	0338.562 1110.765	L&BN NR CTR CB RET 6M W/O BCR @ NE COR VIRO RD & FOOTHILL BLVD 11M E & 9M N/O C/L INT	Y 4515
LA CANADA (1995)	0338.249 1109.739	CS MON FL IN CONC WALK 300MM S/O SLY CF 7M S/O C/L FOOTHILL BLVD & 3M E/O C/L PROD VIRO RD MKD (BM 47-4 1955 RE 63)	Y 4516
LA CANADA (1995)	0357.522 1172.970	L&SPK IN S CB VENTURA ST 4.6M S/O C/L & 3M W/O C/L PROD CASITAS AVE MKD (AE 505)	Y 4524
LA CANADA (1995)	0359.906 1180.792	RD HD SPK NR E EDGE OF CONC DRWY TO HSE #568 VENTURA ST 7.6M S/O C/L & 102M E/O C/L TOLA AVE	Y 4526
LA CANADA (1995)	0360.411 1182.448	L&BN IN N CB OPP DRWY HSE #538 VENTURA ST 4.6M N/O C/L & 1M S/O PP (137M E/O TOLA AVE)	Y 4527
LA CANADA (1995)	0378.488 1241.756	RD HD SPK S CB 2M E/O OF END @ SE COR CASITAS AVE & ALTADENA DR 12M E & 5.5M S/O C/L INT	Y 4534
LA CANADA (1995)	0378.703 1242.461	L&T IN N CB ALTADENA DR 8.2M N/O C/L & 18.3M E/O C/L CASITAS AVE	Y 4535
LA CANADA (1995)	0373.434 1225.175	L&BR NR W EDGE CONC DRWY TO HSE #729 MARIPOSA ST 6.7M N/O C/L & 36.6M E/O C/L CASITAS AVE	Y 4537



JAD-YEAR	ELEV METER/FOOT	DESCRIPTION (INCLUDE QUAD AND YEAR IN DESCRIPTION)	BM NUMBER
LA CANADA (1995)	0364.928 1197.268	L&T NR E EDGE CONC PORCH TO HSE #750 HARRIET ST 20M S/O C/L & 18M W/O C/L CASITAS AVE	Y 4539
LA CANADA (1995)	0340.730 1117.878	L&T E CB WINDSOR AVE 600MM S/O C B 4.6M E/O C/L & 14.6M N/O C/L FIGUEROA DR	Y 4669
LA CANADA (1995)	0340.308 <del>1164.938</del> 1116.494	RD HD SPK IN W CB WINDSOR AVE 8.5M W/O C/L & 1.5M N/O C/L PROD FIGUEROA DR MKD (AE 248)	Y 4670
PASADENA (1995)	0346.236 1135.943	CS MON IN WELL 200MM DN NR C/L INT LINCOLN AVE & FIGUEROA DR (TO W) NLY MOST MON MKD (TRAV STA ALTADENA E 2 1940 RE 1277)	Y 4683
BASELINE (1995)	0346.874 1138.036	BT SPK IN E CB 600MM E/O BCR @ NE COR LINCOLN AVE & FIGUEROA DR 8.2M E & 12M N/O C/L INT	Y 4684
PASADENA (1995)	0331.272 1086.848	L&T IN E END CONC WALK TO HSE #294 WOODBURY RD 7.4M S/O CF & 16.5M S/O C/L MKD (BM) 183M W/O GLENROSE AVE	Y 4686
LA CANADA (1995)	0404.196 1326.100	CRESCENTA WATER CO MON IN CB RET 5M S/O BCR @ NW COR MONTROSE AVE & BRIGGS AVE 23M N & 6M W/O C/L INT	Y 4730
LA CANADA (1995)	0402.527 1320.624	RDBM TAG IN S CB MONTROSE AVE 9M E/O BCR 12M S/O C/L & 38M E/O C/L FLORENCITA DR	Y 4731
PASADENA (1995)	0294.297 0965.539	L&T IN W CB 300MM N/O BCR @ NW COR SIERRA MADRE VILLA AVE & MESITA RD 11M N & 8M W/O C/L INT	Y 4794
PASADENA (1995)	0294.192 0965.195	BM MON IN WELL 250MM DN ON OR NR C/L SIERRA MADRE VILLA & 14M N/O C/L MESITA RD	Y 4795
PASADENA (1995)	0334.105 1096.143	RDBM TAG S CB 300MM W BCR @ SW COR SIERRA MADRE VILLA AVE & E VILLA KNOLLS DR 11.6M W & 4.6M S/O C/L INT	Y 4796
PASADENA (1995)	0335.216 1099.788	RDBM TAG W CB 300MM N BCR @ NW COR SIERRA MADRE VILLA AVE & E VILLA KNOLLS DR 14M N & 5.5M W/O C/L INT	Y 4797
PASADENA (1995)	0366.633 1202.862	L&T IN CONC ROCK WALL ON OR NR C/L PROD BARHITE ST (TO THE E) & 6.7M W/O SIERRA MADRE VILLA AVE	Y 4798
PASADENA (1995)	0368.196 1207.990	L&T CONC ROCK WALL 43FT W & 13FT S/O C/L INT SIERRA MADRE VILLA AVE & BARHITE ST (TO THE W) 3.4M W/O BEG WALL RET	Y 4799

JAD-YEAR	ELEV METER/FOOT	DESCRIPTION (INCLUDE QUAD AND YEAR IN DESCRIPTION)	BM NUMBER
PASADENA (1995)	0392.453 1287.573	RDBM TAG IN W CB 300MM S/O BCR @ SW COR SIERRA MADRE VILLA AVE & E VILLA MESA RD 13M S & 5.5M W/O C/L INT	Y 4800
PASADENA (1995)	0395.287 1296.871	RDBM TAG IN W CB 300MM N/O BCR @ NW COR SIERRA MADRE VILLA AVE & E VILLA MESA RD 13M N & 5.5M W/O C/L INT	Y 4801
PASADENA (1995)	0290.555 0953.263	RDBM TAG IN THE 1ST CONC STEP TO FIRE STA #66 @ 2764 EATON CYN DR 13.4M S/O C/L & 90M W/O C/L KINNELOA CYN RD	Y 4809
LA CANADA (1995)	0343.254 1126.159	RDBM TAG IN SE COR OF CONC VALVE BOX 15M N/O C/L HIGHLAND DR NR INT BERKSHIRE AVE	Y 4877
LA CANADA (1995)	0371.081 1217.455	RDBM TAG IN NLY CB DOVER RD 5M N/O C/L & 7.6M WLY/O C/L HIGHLAND DR (1.5M W/O END CB)	Y 4881
LA CANADA (1995)	0371.059 1217.383	L&T IN SLY CB DOVER RD 3.7M S/O C/L & 30M W/O APPROX C/L HIGHLAND DR (5M W/O END CB)	Y 4882
LA CANADA (1995)	0386.740 1268.829	L&T N CB HIGHLAND DR 2M E/O BCR @ NE COR ALTA VISTA DR & HIGHLAND DR 17M E & 4.6M N/O C/L INT	Y 4883
LA CANADA (1995)	0387.889 1272.599	L&T IN W CB 300MM N/O BCR @ NW COR HIGHLAND DR & ALTA VISTA DR 11M N & 4.6M W/O C/L INT	Y 4884
LA CANADA (1995)	0650.205 2133.214	RDBM TAG IN N CB 300MM W/O BC MARKRIDGE RD 4.6M N/O C/L & 50.3M E/O C/L PINE CONE RD	Y 4901
LA CANADA (1995)	0630.807 2069.573	L&T IN S CB 300MM W/O BCR @ SW COR MARKRIDGE RD & RAMSDELL AVE 13M W & 4.6M S/O C/L INT	Y 4904
LA CANADA (1995)	0618.827 2030.268	RDBM TAG IN W CB PENNSYLVANIA AVE 1M S/O BCR 5.5M W/O C/L & 11.6M S/O C/L MARKRIDGE RD	Y 4906
LA CANADA (1995)	0558.445 1832.165	RDBM TAG S CB ORANGE AVE 600MM W/O BCR 8.5M S/O C/L & 12M W/O C/L PENNSYLVANIA AVE	Y 4910
PASADENA (1995)	0307.609 1009.214	USC&GS MON IN E CB ALTADENA DR NR N END C B 9.8M E/O C/L & 40M N/O C/L PROD VERANADA AVE MKD (Z 172 RESET 1968)	Y 4942
PASADENA (1995)	0306.714 1006.278	RD HD SPK IN E CB @ BCR SE COR NEW YORK DR & HARDING AVE 11M S & 6M E/O C/L INT MKD (AE 11)	Y 4947
PASADENA (1995)	0317.841 1042.783	RDBM TAG IN E CB 7M N BCR @ NE COR NEW YORK DR & PEPPER DR 15M N & 5.5M E/O C/L INT	Y 4949

JAD-YEAR	ELEV METER/FOOT	D E S C R I P T I O N (INCLUDE QUAD AND YEAR IN DESCRIPTION)	BM NUMBER
PASADENA (1995)	0327.161 1073.361	RDBM TAG IN E CB MIDLOTHIAN DR 25M N/O BCR 6M E/O C/L & 36M N/O C/L NEW YORK DR	Y 5058
PASADENA (1995)	0345.711 1134.220	RDBM TAG IN W CB ALLEN AVE 15M N/O BCR 6M W/O C/L & 34M N/O C/L NEW YORK DR	Y 5060
PASADENA (1995)	0344.869 1131.458	CS MON IN WALK 600MM N/O CF 7M W/O BCR @ NW COR NEW YORK DR & ALLEN AVE 26M W & 7M N/O C/L INT MKD (ALTADENA K 3 RM NO 1 1960 RE 5869)	Y 5061
PASADENA (1995)	0350.080 1148.554	RDBM TAG IN E CB 10M S/O BCR @ SE COR NEW YORK DR & SIERRA BONITA AVE 20M S & 4.6M E/O C/L INT	Y 5062
PASADENA (1995)	0350.569 1150.158	L&SPK S CB 1M W/O BCR @ SW COR NEW YORK DR & SIERRA BONITA AVE 11M W & 5.5M S/O C/L INT	Y 5063
PASADENA (1995)	0352.283 1155.782	SPK IN S CB 1M W/O BCR @ SW COR NEW YORK DR & HOLLISTON AVE 9M W & 5.5M S/O C/L INT	Y 5065
PASADENA (1995)	0351.962 1154.729	RDBM TAG IN TOP 300MM HIGH CONC RETAINING WALL 4M E/O E CF 4.5M S/O BCR @ SE COR NEW YORK DR & MAR VISTA AVE 12M S & 9M E/O C/L INT	Y 5066
PASADENA (1995)	0338.668 1111.113	L&SPK N CB NEW YORK DR 7M E/O BCR 6M N/O C/L & 19M E/O C/L MOLINO AVE	Y 5070
PASADENA (1995)	0335.129 1099.502	L&T IN N SIDE OF DRWY TO HSE #611 MADISON AVE 9M E/O C/L & 38M N/O C/L WOODBURY RD	Y 5072
BASELINE (1995)	0398.268 1306.651	CS MON IN WELL 300MM E/O C/L LINCOLN AVE & 2.4M S/O C/L LOMA ALTA DR MKD (TRA STA MOUNT LOWE E 12 RE 2177 1940)	Y 5077
BASELINE (1995)	0397.980 1305.706	L&T NR N END CONC WALK TO HSE #748 LOMA ALTA DR 9.4M S/O C/L & 20M E/O C/L LINCOLN AVE	Y 5078
PASADENA (1995)	0414.421 1359.646	L&T NR S OF END WALK TO HSE #513 LOMA ALTA DR 9.4M N/O C/L & 12M E/O C/L THURIN AVE	Y 5080
PASADENA (1995)	0430.626 1412.812	CS MON IN WELL @ C/L INT LOMA ALTA DR & OLIVE AVE MKD (CS RE 5869)	Y 5081
PASADENA (1995)	0431.320 1415.089	L&BR IN S CB @ BCR SE COR LOMA ALTA DR & OLIVE AVE 7.3M E & 5.8M S/O C/L INT	Y 5082
PASADENA (1995)	0452.805 1485.578	BT SPK N CB 300MM W BCR @ NW COR GLENROSE AVE & LOMA ALTA DR 7M W & 6M N/O C/L INT MKD AE 421	Y 5083
PASADENA (1995)	0453.341 1487.336	RDBM TAG IN S CB 1M E/O BCR @ SE COR GLENROSE AVE & LOMA ALTA DR 6M S & 6M E/O C/L INT	Y 5084

JAD-YEAR	ELEV METER/FOOT	DESCRIPTION (INCLUDE QUAD AND YEAR IN DESCRIPTION)	BM NUMBER
PASADENA (1995)	0473.630 1553.901	SPK IN N CB 2.4M W/O BCR @ NW COR LOMA ALTA DR & FAIR OAKS AVE 9M W & 6M N/O C/L INT	Y 5085
PASADENA (1995)	0473.137 1552.284	L&T IN S CB 1.2M E/O BCR @ SE COR FAIR OAKS AVE & WAPELLO ST 16M E & 4.6M S/O C/L INT	Y 5086
PASADENA (1995)	0502.929 1650.026	LACE TAG IN S CB 300MM W/O BCR @ SW COR LOMA ALTA DR & ALTA PINE DR 13M W & 6M S/O C/L INT	Y 5089
PASADENA (1995)	0515.308 1690.640	L&BN IN N CB 300MM E/O BCR @ NE COR LOMA ALTA DR & CANON BLVD 15M E & 4.6M N/O C/L INT	Y 5091
PASADENA (1995)	0535.419 1756.621	CS MON IN WELL @ C/L INT LOMA ALTA DR & MORENGO AVE MKD (RE 2177)	Y 5092
PASADENA (1995)	0536.779 1761.082	LACE TAG IN N CB LOMA ALTA DR 6M N/O C/L & 7.3M E/O C/L PROD MORENGO AVE	Y 5093
PASADENA (1995)	0524.244 1719.957	BT SPK IN S CB 600MM E/O BCR @ SE COR LAKE AVE & MOUNT CURVE AVE 18M E & 4.6M S/O C/L INT MKD (AE 725)	Y 5097
PASADENA (1995)	0491.217 1611.601	BT SPK E CB 600MM S BCR @ NE COR WAPELLO ST & LAKE AVE 21M N & 7.6M E/O C/L INT MKD (AE 597A)	Y 5098
PASADENA (1995)	0488.254 1601.880	RDBM TAG IN E CB 600MM N/O BCR @ SE COR LAKE AVE & WAPELLO ST 11M S & 7.6M E/O C/L INT	Y 5099
PASADENA (1995)	0454.364 1490.693	CS MON IN WELL @ C/L INT LAKE AVE & DOLORES DR TO THE E MKD (RE 2177)	Y 5100
PASADENA (1995)	0453.664 1488.396	BT SPK IN E CB 1.5M S BCR @ SE COR DOLORES DR & LAKE AVE 8.5M E & 10M S/O C/L INT MKD (AE 31)	Y 5101
PASADENA (1995)	0420.995 1381.214	CS MON @ C/L INT ALTADENA DR & HOLLISTON AVE MKD (RE 2177)	Y 5113
PASADENA (1995)	0420.593 1379.896	L&SPK IN CONC HDWL @ SE COR ALTADENA DR & HOLLISTON AVE 9M S & 6.4M E/O C/L INT	Y 5114
PASADENA (1995)	0351.895 1154.509	USC&GS MON IN TOP OF CONE SHAPE ROCK 17M N/O C/L ALTADENA DR & 9.8M E/O E CB PROD ROOSEVELT AVE MKD (A-173 1934)	Y 5115
PASADENA (1995)	0272.113 0892.757	L&BR IN E CB 3M S/O BCR @ SE COR SIERRA MADRE BLVD & SUNNYSIDE AVE 19M S & 5.5M E/O C/L INT	Y 5213
PASADENA (1995)	0232.543 0762.935	DPW BM TAG IN N CB 1M E/O BCR @ NE COR ALTADENA DR & FOOTHILL BLVD 19M E & 10M N/O C/L INT	Y 5214

AD-YEAR	ELEV METER/FOOT	DESCRIPTION (INCLUDE QUAD AND YEAR IN DESCRIPTION)	BM NUMBER
LA CANADA (1995)	0585.371 1920.505	RDBM TAG IN E CB 300MM S/O BCR @ SE COR BRIGGS AVE & HENRIETTA AVE 13M S & 6.4M E/O C/L INT	Y 5653
LA CANADA (1995)	0586.964 1925.731	RDBM TAG IN E CB 300MM N/O BCR @ NE COR BRIGGS AVE & HENRIETTA AVE 13M N & 6.4M E/O C/L INT	Y 5654
LA CANADA (1995)	0618.704 2029.865	RDBM TAG IN E CB 300MM N/O BCR @ NE COR BRIGGS AVE & PICKENS CYN RD 16M N & 6.4M E/O C/L INT	Y 5655
LA CANADA (1995)	0621.220 2038.119	RDBM TAG IN W CB BRIGGS AVE 4M S/O END OF CB 6.4M W/O C/L & 46M N/O C/L PROD PICKENS CYN RD	Y 5656
LA CANADA (1995)	0635.851 2086.121	RDBM TAG IN CONC SLAB @ EDGE OF RD 5.5M E/O C/L BRIGGS AVE & 12.8M S/O C/L PROD OLIVE AVE	Y 5657
PASADENA (1995)	0404.081 1325.722	RD HD SPK IN S CB (SERV RD) 300MM E/O BCR @ SE COR FAIR OAKS AVE & ALTADENA DR 18M S & 18M E/O C/L INT MKD (AE 256)	Y 6484
PASADENA (1995)	0414.302 1359.256	RD HD SPK IN N CB OF BRIDGE ABUT 3.7M W/O BCR @ NW COR ALTADENA DR & CREST DR 16.2M W & 6M N/O APPROX C/L INT MKD (BM AE 779)	Y 6485
PASADENA (1995)	0422.524 1386.231	CS MON IN WELL 250MM DN @ C/L INT ALTADENA DR & PORTER AVE MKD (RE 2177)	Y 6488
PASADENA (1995)	0422.522 1386.224	RD HD SPK S CB 300MM W/O BCR @ SW COR ALTADENA DR & TANOBLE DR 5M S & 8.2M W/O C/L INT MKD (BM NO 6)	Y 6489
PASADENA (1995)	0423.067 1388.012	RDBM TAG W CB 300MM N/O BCR @ NW COR ALTADENA DR & TANOBLE DR 12 N & 4.6M W/O C/L INT	Y 6490
PASADENA (1995)	0406.805 1334.659	CSBM MON IN WELL 300MM DN @ NW COR ALTADENA DR & CRESCENT DR (WLY) 20M W & 8.2M N/O C/L INT MKD BM (24-30 1952)	Y 6491
PASADENA (1995)	0392.790 1288.679	CSBM IN E END C B 1M W/O BCR @ NE COR 15M N/O C/L ALTADENA DR & 17.4M E/O C/L CRESCENT DR E MKD (BM 24-31A 1963 RE 5869)	Y 6494
PASADENA (1995)	0349.303 1146.005	SQ HD SPK IN SLY CB ALTADENA DR 3M E/O BCR 6.7M S/O C/L & 21M E/O C/L ROOSEVELT AVE MKD (AE 68)	Y 6497
PASADENA (1995)	0328.042 1076.251	SPK IN N CB GLEN CYN RD @ BCR 4.6M N/O C/L & 5.5M W/O C/L HARDING AVE MKD (AE 204)	Y 6498
PASADENA (1995)	0327.284 1073.764	CS MON IN WELL 200MM DN @ C/L INT HARDING AVE GLENN CYN RD MKD (RE 63)	Y 6499

QUAD-YEAR	ELEV METER/FOOT	DESCRIPTION (INCLUDE QUAD AND YEAR IN DESCRIPTION)	BM NUMBER
PASADENA (1995)	0314.408 1031.520	RDBM TAG IN E CB ALTADENA DR 9M E/O C/L & 6M N/O C/L PROD BERENDO ST	Y 6500
PASADENA (1995)	0418.041 1371.523	L&T IN E CB @ NE COR ALTADENA DR & PINECREST DR 14M N & 7.3M E/O C/L INT 4.5M N/O N END C B	Y 6503
BASELINE (1995)	0372.702 1222.773	SPK IN S CB 1M E/O BCR @ SE COR LINCOLN AVE & MENDOCINO ST 19M E 6.7M S/O C/L INT	Y 6505
BASELINE (1995)	0383.069 1256.786	CS MON @ C/L INT LINCOLN AVE & ALTADENA DR MKD (RE 63)	Y 6506
BASELINE (1995)	0392.479 1287.658	L&T IN CTR CONC DR TO HSE #3180 LINCOLN AVE 11.6M E/O C/L & 74M S/O C/L PALM ST	Y 6507
PASADENA (1995)	0446.848 1466.034	SPK IN S CB LOMA ALTA DR 1.2M E/O C/L PROD CHANEY TRAIL MKD (AE 420)	Y 6509
PASADENA (1995)	0533.093 1748.989	SPK IN E CB RET 300MM N/O BCR @ SE COR LAKE AVE & ALTA PINE DR 17M S & 7.6M E/O C/L INT	Y 6511
PASADENA (1995)	0398.410 1307.117	SPK IN N CB 1.5M W/O BCR @ NW COR ALTADENA DR & GLENROSE AVE 9.8M N & 15M W C/L INT MKD (AE 253)	Y 6519
PASADENA (1995)	0398.507 1307.435	CS MON IN WELL @ C/L INT ALTADENA DR & GLENROSE AVE MKD (RE 63)	Y 6520
PASADENA (1995)	0352.124 1155.260	L&BN IN CB E CB KINNELOA CYN RD 4.6M E/O C/L & 44M S/O C/L DRWY TO HSE #2020 @ S END C B	Y 6533
PASADENA (1995)	0387.399 1270.992	L&T IN S CB @ BCR SW COR KINNELOA CYN RD & BRAMBLING LANE 10.7M W & 4.6M S/O C/L INT	Y 6534
PASADENA (1995)	0389.297 1277.219	FC MON FL IN W CB 6M N/O BCR @ NW COR KINNELOA CYN RD & BRAMBLING LANE 17M N & 4M W/O C/L INT MKD (BM 60-108)	Y 6535
PASADENA (1995)	0354.145 1161.891	BM MON IN WELL ON C/L SIERRA MADRE VILLA & 10.7M S/O C/L FAIRPOINT ST MKD (BM)	Y 6536
PASADENA (1995)	0260.756 0855.497	CS MON FL IN N CB (S BBL) SIERRA MADRE 7.3M E BCR 7.6M N/O C/L & 27M E/O C/L SIERRA MADRE VILLA MKD (BM 24-44A 1963 RE 5869)	Y 6539
PASADENA (1995)	0238.657 0782.994	L&T IN W CB @ BCR NW COR SIERRA MADRE VILLA & ORANGE GROVE BLVD 21M N & 12.2M W/O C/L INT	Y 6541
PASADENA (1995)	0237.890 0780.477	RAMSET IN S CB RET 5M E/O BCR @ SW COR ORANGE GROVE BLVD & SIERRA MADRE VILLA AVE 14M W & 10M S/O C/L INT	Y 6542

JAD-YEAR	ELEV METER/FOOT	DESCRIPTION (INCLUDE QUAD AND YEAR IN DESCRIPTION)	BM NUMBER
PASADENA (1995)	0255.840 0839.368	CS MON 1.2M E/O E CF 3M N/O BCR @ NE COR PALOMA DR & ALTADENA DR 17M N & 10.7M E/O C/L INT MKD (SIERRA MADRE A-5A RM 4 1963 RE 5869)	Y 6550
LA CANADA (1995)	0443.623 1455.453	SPK IN SW COR <b>OUT</b> 12.5M S/O C/L FOOTHILL BLVD & 53M E/O C/L EL CAMINO CORTO (TO N)	Y 6557
LA CANADA (1995)	0457.034 1499.452	RDBM TAG IN N CB 1.5N W/O BCR @ NW COR FOOTHILL BLVD & CASTLE RD 24M W & 12.2M N/O C/L INT	Y 6558
LA CANADA (1995)	0425.274 1395.253	RDBM TAG E END CHANNEL HDWL 2M N/O N CF 58M E & 14M N/O C/L INT MONTROSE AVE & PENNSYLVANIA AVE	Y 6561
LA CANADA (1995)	0501.125 1644.108	RDBM TAG IN S CB 300MM W/O BCR @ SW COR BRIGGS AVE & FAIRMOUNT AVE 14M W & 6M S/O C/L INT	Y 6577
LA CANADA (1995)	0502.155 1647.487	BT SPK IN N CB @ BCR NW COR BRIGGS AVE & FAIRMOUNT AVE 13.7M W & 6M N/O C/L INT	Y 6578
LA CANADA (1995)	0537.758 1764.294	L&BN CONC FTG OF BLOCK WL @ NW COR BRIGGS AVE & LOS AMIGOS ST 7.6M N & 6M W/O C/L INT MKD (BM)	Y 6579
LA CANADA (1995)	0597.060 1958.854	RDBM TAG IN N CB ROCKDELL ST 5.2M N/O C/L & 10.4M W/O C/L ROSEMONT AVE	Y 6581
LA CANADA (1995)	0596.909 1958.359	RDBM TAG IN S CB 300MM W BCR @ SW COR ROCKDELL ST & ROSEMONT AVE 14M W & 5.2M S/O C/L INT	Y 6582
LA CANADA (1995)	0649.975 2132.460	RDBM TAG IN SE COR BRIDGE 1M W/O E END 39M E/O C/L PINECONE RD & 4M S/O C/L MARKRIDGE RD	Y 6585
LA CANADA (1995)	0533.975 1751.883	RDBM TAG IN S CB EL CAMINITO ST 300MM E/O BCR 5.5M S/O C/L & 23.5M E/O C/L PENNSYLVANIA AVE	Y 6588
LA CANADA (1995)	0448.084 1470.089	L&SPK IN SLY CB 5FT WLY BCR @ SWLY COR 58FT WLY C/L PENNSYLVANIA AVE & 20FT SLY C/L ALTURA AVE MKD (BM)	Y 6592
LA CANADA (1995)	0385.777 1265.670	RDBM TAG IN S CB HIGHLAND DR 300MM W/O C B 7.3M S C/L HIGHLAND DR & 29M E/O C/L CHEVY CHASE DR	Y 6605
LA CANADA (1995)	0385.780 1265.680	RDBM TAG W CB CHEVY CHASE 1M N/O C B 5.5M W/O C/L & 30M N/O C/L HIGHLAND DR	Y 6606
LA CANADA (1995)	0386.600 1268.370	RDBM TAG E CB DURHAM PL 300MM S/O CB END 2.7M E/O C/L & 10.4M S/O C/L CHEVY CHASE DR	Y 6607
LA CANADA (1995)	0387.261 1270.539	L&BN IN W CB WINDSOR PL 300MM S/O BCR 3M W/O C/L & 12.5M S/O C/L CHEVY CHASE DR MKD (BM)	Y 6609

JAD-YEAR	ELEV METER/FOOT	D E S C R I P T I O N (INCLUDE QUAD AND YEAR IN DESCRIPTION)	BM NUMBER
LA CANADA (1995)	0377.460 1238.383	L&BN IN S END C B 9M W/O C/L CHEVY CHASE DR & 6M N/O C/L FLINTRIDGE AVE MKD (BM)	Y 6611
LA CANADA (1995)	0375.419 1231.687	RDBM TAG N END HDWL 9.8M W/O C/L CHEVY CHASE DR & 33.5M N/O C/L FLINTRIDGE AVE	Y 6612
LA CANADA (1995)	0366.458 1202.288	L&T IN E CB CHEVY CHASE DR 4.3M E/O C/L ON OR NR C/L PROD DESCANSO DR	Y 6615
LA CANADA (1995)	0380.354 1247.878	L&BN IN W CB DESCANSO DR 300MM N/O BCR 8.5M W/O C/L & 17M N/O C/L PADRES TRAIL	Y 6617
LA CANADA (1995)	0380.734 1249.125	FC TAG IN ELY CB DESCANSO DR 8.5M E/O C/L & 19M N/O C/L PADRES TRAIL	Y 6618
LA CANADA (1995)	0389.314 1277.274	L&BR IN WLY CB DESCANSO DR 300MM S/O BCR 8.5M W/O C/L & 16M S/O C/L ENCINAS DR	Y 6619
LA CANADA (1995)	0390.550 1281.329	RDBM TAG IN ELY CB DESCANSO DR 2M N/O BCR 8.5M E/O C/L & 19.5M N/O C/L ENCINAS DR	Y 6620
LA CANADA (1995)	0396.379 1300.453	BT SPK IN S CB DESCANSO DR 8.5M S/O C/L & 1.2M E/O C/L PROD FAIRLAWN DR	Y 6621
LA CANADA (1995)	0397.113 1302.862	RDBM TAG IN N CB DESCANSO DR 300MM W/O BCR 8.5M N/O C/L & 16.5M W/O C/L FAIRLAWN DR	Y 6622
LA CANADA (1995)	0412.459 1353.209	RDBM TAG IN W CB 1M S/O BCR @ SW COR DESCANSO DR & VERDUGO RD 18M S & 8.5M W/O C/L INT	Y 6623
LA CANADA (1995)	0412.288 1352.648	L&T IN E CB 150MM S/O BCR @ SE COR DESCANSO DR & VERDUGO RD 18M S & 8.5M E/O C/L INT	Y 6624
BASELINE (1995)	0400.953 1315.460	CS TAG IN E CB LINCOLN AVE 6M E/O C/L & 8.8M S/O C/L CANYON CREST RD	Y 7683
BASELINE (1995)	0401.430 1317.025	CS TAG IN E CB LINCOLN AVE 6M E/O C/L ON C/L PROD CANYON CREST RD	Y 7684
LA CANADA (1995)	0330.694 1084.952	RDBM IN WELL 200MM DN @ C/L INT WOODBURY RD & CASITAS AVE MKD (LACO RD 1966)	Y 7706
LA CANADA (1995)	0331.028 1086.048	RDBM TAG IN S CB 15M S/O BCR @ SE COR WOODBURY RD & CASITAS AVE 29M S/O BCR & 12.2M S/O C/L INT	Y 7707
BASELINE (1995)	0332.354 1090.398	RDBM TAG W CB 600MM N/O BCR @ NW COR LINCOLN AVE & WOODBURY RD 3.5M N & 9M W/O C/L INT	Y 7709
LA CANADA (1995)	0563.089 1847.401	RDBM TAG IN E CB 300MM N BCR @ NE COR BRIGGS AVE & ORANGE COVE AVE 14.6M N & 6M E/O C/L INT	Y 7715



JAD-YEAR	ELEV METER/FOOT	DESCRIPTION (INCLUDE QUAD AND YEAR IN DESCRIPTION)	BM NUMBER
LA CANADA (1995)	0560.444 1838.723	RDBM TAG IN E CB 300MM S/O BCR @ SE COR BRIGGS AVE & ORANGE COVE AVE 14.6M S & 6M E/O C/L INT	Y 7716
LA CANADA (1995)	0356.756 1170.457	L&BN IN E CB 600MM S/O C B @ NE COR VENTURA ST & STERLING PL 14M N & 4M E/O C/L INT MKD (BM)	Y 7717
LA CANADA (1995)	0356.734 1170.385	SQ SPK W CB 1.5M N/O END CB @ NW COR VENTURA ST & STERLING PL 11M N & 4M W/O C/L INT MKD (BM 51)	Y 7718
PASADENA (1995)	0341.918 1121.776	RDBM TAG E CB 600MM N/O BCR @ NE COR WOODBURY RD & FAIR OAKS AVE 23M N & 13M E/O C/L INT	Y 7719
PASADENA (1995)	0341.779 1121.320	RDBM TAG W CB 450MM N/O BCR @ NW COR WOODBURY RD & FAIR OAKS AVE 23M N & 13M W/O C/L INT	Y 7720
PASADENA (1995)	0333.204 1093.187	SPK IN W CB 21M N/O BCR @ NW COR WOODBURY RD & GLENROSE AVE 41M N & 4.6M W/O C/L MKD (AE 536)	Y 7721
PASADENA (1995)	0410.584 1347.058	SPK IN N CB 300MM E BCR @ NE COR ALTADENA DR & MARENGO AVE 17M E & 6M N/O C/L INT MKD (AE 269)	Y 7723
PASADENA (1995)	0314.273 1031.077	FC TAG IN S CB 1M W/O BCR @ SW COR ALTADENA DR & BERENDO ST 18.3M W & 9M S/O C/L INT	Y 7725
PASADENA (1995)	0300.122 0984.650	RDBM TAG W CB 600MM N/O BCR @ NW COR ALTADENA DR & NEW YORK DR 26M N & 9M W/O C/L INT	Y 7726
PASADENA (1995)	0391.198 1283.455	LACS MON IN WELL @ C/L INT ALTADENA DR & OLIVE AVE MKD (RE 5869)	Y 7728
PASADENA (1995)	0266.176 0873.279	RDBM TAG IN W CB 300MM N/O BCR @ NW COR CASA GRANDE ST & ALTADENA DR 14M N & 9M W/O C/L INT	Y 9462
PASADENA (1995)	0277.954 0911.921	RD MON IN WELL C/L INT ALTADENA DR & WASHINGTON BLVD MKD (LACRD 1971)	Y 9464
PASADENA (1995)	0346.221 1135.893	RDBM TAG E CB RET 300MM N/O BCR @ SE COR NEW YORK DR & LAKE AVE 15M S & 10.4M E/O C/L INT	Y 9467
PASADENA (1995)	0347.544 1140.234	RDBM TAG IN E CB 300MM S/O BCR @ NE COR NEW YORK DR & LAKE AVE 18M N & 10.4M E/O C/L INT	Y 9468
PASADENA (1995)	0336.382 1103.613	RD BR CAP MON IN WELL @ C/L INT SANTA ROSA AVE (TO THE N) & WOODBURY RD MKD (LACRD 1970)	Y 9469
PASADENA (1995)	0337.238 1106.422	CSBM MON 300MM N/O N CF @ BCR NW COR SANTA ROSA AVE & WOODBURY RD 14.6M W & 13M N/O C/L INT MKD (BM 24-15A 1971 RE 5869)	Y 9470

JAD-YEAR	ELEV METER/FOOT	DESCRIPTION (INCLUDE QUAD AND YEAR IN DESCRIPTION)	BM NUMBER
PASADENA (1995)	0342.459 1123.551	RDBM TAG N CB 1M E/O BCR @ NW COR SANTA ANITA AVE & WOODBURY RD 22M W & 12.5M N/O C/L INT	Y 9471
PASADENA (1995)	0417.050 1368.272	RDBM TAG N CB NORTH VILLA HEIGHTS RD (W) 15FT E OF E GATE POST @ END OF RD N SIDE 156M W/O INT WITH N VILLA HEIGHTS RD (N) 3M N/O C/L & 3M E/O & OPP WLY MOST C/L DRWY TO LOT #2097	Y 9472
PASADENA (1995)	0416.580 1366.730	RDBM TAG 300MM E/O SW EDGE CONC WALK @ BASE OF WALL 700MM N/O E GATE POST @ END OF RD & OPP W EDGE WLY MOST DRWY TO LOT #2079 163M W/O C/L N VILLA HEIGHTS RD (W)	Y 9473
PASADENA (1995)	0292.981 0961.222	RDBM TAG IN N CB EATON CYN RD 300MM E/O BCR 5M N/O C/L & 14M E/O C/L KINNEOLA CYN RD	Y 9474
PASADENA (1995)	0418.458 1372.891	L&PK NAIL W CB 600MM N/O BCR @ NW COR ALTADENA DR & PINECREST DR 23M N & 4.6M W/O C/L INT	Y 9475
PASADENA (1995)	0423.173 1388.360	RDBM TAG E CB 300MM N/O BCR @ NE COR ALTADENA DR & PORTER AVE 9M N & 4.3M E/O C/L INT	Y 9476
PASADENA (1995)	0419.108 1375.023	L&T NR CTR CB RET @ NE COR ALTADENA DR & LAKE AVE 16.2M N & 16.2M E/O C/L INT	Y 9477
PASADENA (1995)	0418.733 1373.793	CSBM MON 5M N/O BCR @ NW COR ALTADENA DR & LAKE AVE 27M N & 9.8M W/O C/L INT MKD (BM 24-25A)	Y 9478
PASADENA (1995)	0287.654 0943.745	L&T IN W CB 300MM N/O BCR @ NW COR ALTADENA DR & GARFIAS DR 12.5M N & 9M W/O C/L INT	Y 9479
PASADENA (1995)	0307.599 1009.181	L&T IN S CB 1M W/O BCR @ SW COR NEW YORK DR & HARDING AVE 13M W & 7.6M S/O C/L INT (S)	Y 9480
PASADENA (1995)	0406.434 1333.442	RDBM TAG W CB S END C B @ NW COR ALTADENA DR & FAIROAKS AVE 16.8M N & 5M W/O C/L INT	Y 9483
PASADENA (1995)	0342.280 1122.964	CSBM MON IN N END C B 13.7M N/O BCR @ NW COR WOODBURY RD & FAIR OAKS AVE 37M N & 13.4M W/O C/L INT MKD (BM 24-16A 1971 RE 5869)	Y 9484
PASADENA (1995)	0394.821 1295.342	L&T NR CTR CB RET @ NE COR LAKE AVE & MARCHETA ST 9M N & 10.7M E/O C/L INT	Y 9485
PASADENA (1995)	0394.860 1295.470	L&T IN W CB RET 600MM N/O BCR @ SW COR LAKE AVE & MARIPOSA ST 18M S & 10.4M W/O C/L INT	Y 9486
PASADENA (1995)	0380.977 1249.922	CSBM MON @ BCR NE COR LAKE AVE & MENDOCINO ST 14.6M N & 10M E/O C/L INT MKD (24-26D 1975)	Y 9487

JAD-YEAR	ELEV METER/FOOT	DESCRIPTION (INCLUDE QUAD AND YEAR IN DESCRIPTION)	BM NUMBER
PASADENA (1995)	0361.989 1187.626	L&T IN E CB RET 1M S/O BCR @ NE COR LAKE AVE & BOSTON ST 13.4M N & 10M E/O C/L INT	Y 9489
PASADENA (1995)	0361.622 1186.422	L&T IN W CB LAKE AVE 10M W/O C/L & 12M N/O C/L PROD BOSTON ST	Y 9490
LA CANADA (1995)	0331.001 1085.959	RDBM TAG W END C B 14M E BCR @ NE COR WOODBURY RD & WINDSOR AVE 26M E & 13.4M N/O C/L INT	Y 9542
LA CANADA (1995)	0330.553 1084.489	RDBM TAG S CB 300MM W/O BCR @ SW COR WOODBURY RD & WINDSOR AVE 26M W & 13.4M S/O C/L INT	Y 9543
LA CANADA (1995)	0377.188 1237.491	RDBM TAG IN W CB 300MM N/O BCR @ NW COR OAKWOOD ST & FOOTHILL BLVD 26M N & 6M W/O C/L INT	Y 9547
LA CANADA (1995)	0372.755 1222.947	RDBM TAG IN W CB @ BCR NW COR CASITAS AVE & MARIPOSA ST 8.5M N & 6M W/O C/L INT	Y 9548
LA CANADA (1995)	0466.120 1529.262	RDBM TAG IN N CB 5FT W/O BCR @ NW COR FOOTHILL BLVD & BRIGGS AVE 40FT N & 48FT W/O C/L INT	Y 9952
LA CANADA (1995)	0631.666 2072.391	RDBM TAG SLY CB 1.5M E/O BCR @ SE COR RAMSDELL AVE & MARKRIDGE RD 22M E & 5.5M S/O C/L INT	Y 9953
LA CANADA (1995)	0639.472 2098.001	RDBM TAG IN S CB 300MM W/O BCR @ SW COR BRIGGS AVE & SHIELDS AVE W 4.6M S & 14.3M W/O C/L INT	Y 9956
LA CANADA (1995)	0640.777 2102.283	RDBM TAG IN N CB SHIELDS AVE W 4.6M N/O C/L & 6M E/O C/L PROD BRIGGS AVE	Y 9957
LA CANADA (1995)	0535.566 1757.103	L&BN IN E CB BRIGGS AVE 6.4M E/O C/L & 16M S/O C/L PROD LOS AMIGOS ST	Y 9958
LA CANADA (1995)	0621.260 2038.251	RDBM TAG IN SLY CB MTN PINE DR 600MM W/O BCR 5.5M S/O C/L & 14M W/O C/L PINEGLEN RD	Y 9959
LA CANADA (1995)	0622.001 2040.682	RDBM TAG IN NLY CB MMTN PINE DR 600MM W/O BCR 5.5M N/O C/L & 14.3M W/O C/L PINEGLEN RD	Y 9960
LA CANADA (1995)	0449.726 1475.476	RDBM TAG IN W CB PENNSYLVANIA AVE 300MM N/O BCR 12.5M W/O C/L & 22M N/O C/L ALTURA AVE	Y 9961
LA CANADA (1995)	0424.557 1392.901	L&SPK IN SLY CB MONTROSE AVE 1.5M E/O BCR 11.3M S/O C/L & 40M E/O C/L PENNSYLVANIA AVE	Y 9962
LA CANADA (1995)	0422.648 1386.638	RDBM TAG IN NLY CB MONTROSE AVE 1M W BCR 11.6M N/O C/L & 19M W/O C/L RAMSDELL AVE	Y 9963
LA CANADA (1995)	0421.848 1384.013	SPK&L IN SLY CB MONTROSE AVE 3M W/O BCR 11.6M S/O C/L & 11.6M W/O C/L RAMSDELL AVE MKD (BM)	Y 9964

JAD-YEAR	ELEV METER/FOOT	DESCRIPTION (INCLUDE QUAD AND YEAR IN DESCRIPTION)	BM NUMBER
LA CANADA (1995)	0412.792 1354.302	SPK&L IN SLY CB MONTROSE AVE 4M W/O BCR 11.3M S/O C/L & 15.5M W/O C/L LA CRESCENTA AVE	Y 9965
LA CANADA (1995)	0411.520 1350.129	RDBM TAG IN ELY CB LA CRESCENTA AVE 600MM S/O BCR 9.8M E/O C/L & 17M S/O C/L MONTROSE AVE	Y 9966
LA CANADA (1995)	0410.328 1346.218	RDBM TAG IN SLY CB MONTROSE AVE 4.6M W/O BCR 11M S/O C/L & 13.4M W/O C/L ROSEMONT AVE	Y 9967
LA CANADA (1995)	0402.938 1321.972	RDBM TAG IN SLY CB MONTROSE AVE 600MM W/O BCR 12.2M S/O C/L & 16.5M W/O C/L OCEAN VIEW BLVD	Y 9968
LA CANADA (1995)	0403.810 1324.833	RDBM TAG IN ELY CB OCEAN VIEW BL CB 600MM N/O BCR 9.4M E/O C/L & 19.5M N/O C/L MONTROSE AVE	Y 9969
LA CANADA (1995)	0431.450 1415.516	RDBM TAG IN E CB OCEAN VIEW BLVD 1.5M S/O BCR 9.8M E/O C/L & 13.4M S/O C/L LUANA LN	Y 9970
LA CANADA (1995)	0433.126 1421.014	RDBM TAG IN E CB 1M N/O BCR @ NE COR OCEAN VIEW BLVD & LUANA LN 12.5M N & 9.8M E/O C/L INT	Y 9971
LA CANADA (1995)	0562.279 1844.744	RDBM TAG IN E CB 600MM N/O BCR @ NE COR ORANGE AVE & RAMSDELL AVE 9.8M N & 6M E/O C/L INT	Y 9972
PASADENA (1995)	0351.726 1153.954	RDBM TAG IN W CB 47M S/O & OPP C/L DRWY TO HSE #2020 KINNELOA CYN RD @ S END C B	Y 10090
PASADENA (1995)	0255.085 0836.891	DPW BM TAG E CB 300MM S/O BCR @ SE COR ALTADENA DR & PALOMA DR 16.5M S & 10.7M E/O C/L INT	Y 10291
PASADENA (1995)	0265.700 0871.717	CITY ENGR RCE TAG #5909 IN W CB 300MM S/O BCR @ SW COR ALTADENA DR & CASA GRANDE ST 14M S & 9M W/O C/L INT	Y 10292
PASADENA (1995)	0277.619 0910.822	L&BR IN E CB RET 3M N/O BCR @ SE COR ALTADENA DR & WASHINGTON BLVD 16.5M S & 9.4M E/O C/L INT	Y 10293
PASADENA (1995)	0287.200 0942.255	L&SPK IN E CB ALTADENA DR 9M E/O C/L & 3.7M S/O C/L PROD GARFIAS DR W	Y 10294
PASADENA (1995)	0299.945 0984.070	L&BR IN E CB RET 1M S/O BCR @ NE COR ALTADENA DR & NEW YORK DR 22M N & 9M E/O C/L INT	Y 10295
PASADENA (1995)	0351.691 1153.840	L&SPK IN W CB 1.5M S/O BCR @ SW COR NEW YORK DR & MAR VISTA AVE 5.2M S & 9M W/O C/L INT	Y 10296
BASELINE (1995)	0359.846 1180.595	L&SPK IN E CB 600MM S/O BCR @ SE COR LINCOLN AVE & VENTURA ST 11M S & 7M E/O C/L INT	Y 10297

JAD-YEAR	ELEV METER/FOOT	DESCRIPTION (INCLUDE QUAD AND YEAR IN DESCRIPTION)	BM NUMBER
LA CANADA (1995)	0330.838 1085.424	DPW BM TAG S CB 600MM E/O BCR @ SE COR WOODBURY RD & 210 FRWY OVERPASS BRIDGE #52-2198 14M E & 10M S/O C/L INT (644M W/O C/L WINDSOR AVE)	Y 10298
LA CANADA (1995)	0330.783 1085.244	DPW BM TAG S CB 600MM W/O BCR @ SW COR WOODBURY RD & 210 FRWY OVERPASS BRIDGE #52-2198 29M W & 10M S/O C/L INT (644M W/O C/L WINDSOR AVE)	Y 10299
LA CANADA (1995)	0327.764 1075.339	CS MON IN W CB S END C B 12.5M S/O BCR @ SW COR OAK GROVE DR & BERKSHIRE PL 37M S & 9.8M W/O C/L INT MKD (BM A7 2E RE 22726)	Y 10300
LA CANADA (1995)	0328.352 1077.268	DIV OF HWYS TAG CTR CB RET @ NW COR OAK GROVE DR & BERKSHIRE PL 18M N & 10.7M W/O C/L INT	Y 10301
LA CANADA (1995)	0355.611 1166.700	L&T CTR CB RET @ NW COR FOOTHILL BLVD & HAMPTON RD 16.5M N & 9M W/O C/L INT	Y 10302
LA CANADA (1995)	0364.927 1197.265	DPW BM TAG IN E CB 1M N/O BCR @ NE COR FOOTHILL BLVD & GOULD AVE 18M N & 9M E/O C/L INT @ C B	Y 10303
LA CANADA (1995)	0398.838 1308.521	CS MON FL IN CONC GUTTER IN CTR OF CB RET @ NE COR FOOTHILL BLVD & ANGELES CREST HWY 11.6M N & 16M E/O C/L MKD (MTL A 12 RM 1 RE 5869)	Y 10304
LA CANADA (1995)	0400.562 1314.177	CS MON FL 300MM N/O CF 6M W/O BCR @ NW COR 11M N/O C/L FOOTHILL BLVD & 30M W/O ANGELES CREST HWY MKD (BM 47-7A 1966 RE 5869)	Y 10305
LA CANADA (1995)	0416.771 1367.356	CS MON FL IN S END HDWL 5M W/O BCR @ NE COR 14M N/O FOOTHILL BLVD & 12M E/O LA CANADA BLVD MKD (BM 47-8A 1971 RE 5869)	Y 10306
LA CANADA (1995)	0417.394 1369.400	L&SPK IN N CB 1.5M W/O BCR @ NW COR 11M N/O C/L FOOTHILL BLVD & 20M W/O C/L LA CANADA BLVD	Y 10307
LA CANADA (1995)	0442.725 1452.507	CS MON IN WELL 100MM DN 24M W/O BCR IN WALK 13M N C/L FOOTHILL BL & 11.6M W/O C/L ALTA CANYADA RD MKD (LA CRES K-11 RM-1 1966 RE 5869)	Y 10308
LA CANADA (1995)	0464.227 1523.051	CS TAG IN S CB FOOTHILL BLVD 12.2M S/O C/L ON C/L PROD LITTLETON PL	Y 10309
LA CANADA (1995)	0478.785 1570.814	L&BR IN N CB 6M E/O BCR @ NE COR FOOTHILL BLVD & RAMSDALL AVE 12.2M N & 9.8M E/O C/L INT	Y 10310
LA CANADA (1995)	0482.576 1583.251	L&SPK IN E END C B 11M W BCR @ NW COR FOOTHILL BL & PENNSYLVANIA AVE 38M W & 12.5M N/O C/L INT	Y 10311

JAD-YEAR	ELEV METER/FOOT	DESCRIPTION (INCLUDE QUAD AND YEAR IN DESCRIPTION)	BM NUMBER
PASADENA (1995)	0259.444 0851.193	DPW BM TAG IN SW CB 1FT W/O BCR SIERRA MADRE BL (S BBL) & SIERRA MADRE VILLA 77FT W & 24FT S/O C/L INT	Y 10350
PASADENA (1995)	0407.515 1336.989	L&BN IN MCR @ NW COR ALTADENA DR & CRESCENT DR (WLY) 12.5M N & 10.4M W/O C/L INT	Y 10351
PASADENA (1995)	0414.302 1359.256	CSBM MON IN S CB OF BRIDGE ABUT 7M S/O C/L ALTADENA DR & 16.8M W/O C/L PROD CREST DR MKD (BM 24-28C 1977 RE 22726)	Y 10352
PASADENA (1995)	0524.669 1721.352	BT SPK N CB 3M E/O BCR @ NE COR MOUNT CURVE AVE & LAKE AVE 21M E & 4.6M N/O C/L INT MKD (A-15)	Y 10353
PASADENA (1995)	0379.390 1244.715	L&T IN E CB 1M S/O BCR @ SE COR LAKE AVE & MENDOCINO ST E 15M S & 10M E/O C/L INT	Y 10354
PASADENA (1995)	0247.033 0810.474	DPW BM TAG N CB 300MM E/O BCR @ NE COR SIERRA MADRE BL & WASHINGTON BL 20M E & 8M N/O C/L INT	Y 10355
PASADENA (1995)	0246.190 0807.708	RAMSET&W IN S CB 300MM E/O BCR @ SE COR SIERRA MADRE BLVD (S BBL) & EATON CYN DR 7.3M S & 17M E/O C/L INT	Y 11199
PASADENA (1995)	0247.880 0813.253	DPW BM TAG IN W CB 1M N/O BCR @ NW COR SIERRA MADRE BL & PALOMA ST 24M W & 13M N/O C/L INT	Y 11200
PASADENA (1995)	0372.274 1221.369	DPW BM TAG IN ROCKWALL @ SW COR ALTADENA DR & KENGARY LN (PVT) 10M W & 9M S/O C/L INT	Y 11201
PASADENA (1995)	0394.866 1295.490	DPW BM TAG N CB 600MM E/O END @ NW COR ALTADENA DR & CRESCENT DR E 32M W & 5M N/O C/L INT	Y 11202
PASADENA (1995)	0421.339 1382.343	L&BR IN W CB RET 300MM S/O BCR @ NW COR MAIDEN LN & ALTADENA DR 17.4M N & 6M W/O C/L INT	Y 11203
PASADENA (1995)	0413.628 1357.045	L&T IN S CB @ BCR @ SE COR ALTADENA DR & SANTA ROSA AVE 14.6M W & 5.2M S/O C/L INT	Y 11204
PASADENA (1995)	0413.583 1356.897	L&T IN S CB 300MM W/O BCR @ SW COR ALTADENA DR & SANTA ROSA AVE 17.4M W & 8.5M S/O C/L INT	Y 11205
PASADENA (1995)	0411.803 1351.057	CSBM MON IN E CB S END C B 7M N/O BCR @ NE COR ALTADENA DR & MARENGO AVE 23M N & 6M E/O C/L INT MKD (BM 24-23D 1977 RE 22726)	Y 11206
PASADENA (1995)	0389.955 1279.377	LACO DPW TAG IN W CB 2M S/O BCR @ SW COR OLIVE AVE & ALTADENA DR 12.6M S & 6M W/O C/L INT	Y 11207

JAD-YEAR	ELEV METER/FOOT	D E S C R I P T I O N (INCLUDE QUAD AND YEAR IN DESCRIPTION)	BM NUMBER
PASADENA (1995)	0317.467 1041.556	FC MON IN WALK 1.5M E/O BCR @ NE COR NEW YORK DR & PEPPER TREE DR 18M E & 5.3M N/O C/L INT MKD (BM 60-75)	Y 11208
PASADENA (1995)	0335.397 1100.382	DPW BM TAG IN W CB 1M S/O BCR @ NW COR WOODBURY RD & EL MOLINO AVE (N) 16M N & 7.3M W/O C/L INT	Y 11209
PASADENA (1995)	0346.048 1135.326	DPW BM TAG IN N CB 1M W/O BCR @ NW COR WOODBURY RD & MARENGO AVE 19M W & 12.8M N/O C/L INT	Y 11210
BASELINE (1995)	0331.914 1088.955	L&T IN N CB C/L MEDIAN 46M W/O BCR 61M W/O C/L LINCOLN AVE & 2M N/O C/L WOODBURY RD	Y 11211
PASADENA (1995)	0549.897 1804.120	SPK&W IN AC WALK 5.5M N/O C/L LOMA ALTA DR ON C/L PROD LAKE AVE	Y 11212
PASADENA (1995)	0503.766 1652.772	LACE TAG IN E CB 300MM S/O BCR @ SE COR LOMA ALTA DR & ALTA PINE DR 13M S & 4.6M E/O C/L INT	Y 11213
PASADENA (1995)	0482.433 1582.782	DPW BM TAG IN S CB LOMA ALTA DR 6M S/O C/L & 22M W/O C/L DRWY HSE #160 (OPP SE COR FC R/W)	Y 11214
PASADENA (1995)	0535.060 1755.443	SPK IN S CB E END C B 3M E/O BCR @ SE COR LAKE AVE & ALTA PINE DR 24M E & 5.5M S/O C/L INT	Y 11215
BASELINE (1995)	0395.591 1297.868	L&BR IN E CB 1M N/O BCR @ NE COR LINCOLN AVE & PALM ST 10M N & 6.4M E/O C/L INT	Y 11216
PASADENA (1995)	0225.180 0738.778	LS TAG #2959 IN E CB @ BCR SE COR SIERRA MADRE VILLA AVE & ELECTRIC DR 16M S & 9M E/O C/L INT	Y 11217
PASADENA (1995)	0282.363 0926.386	DPW BM TAG IN SE COR OF CONC DRWY APRON TO HSE #1075 SIERRA MADRE VILLA AVE 4.4M W/O C/L & 21M N/O C/L CALVERT RD	Y 11218
PASADENA (1995)	0319.502 1048.233	L&BR IN SLY CB 1.2M W/O BCR 8.4M W/O C/L SIERRA MADRE VILLA AVE & 6.7M S/O C/L TREVAN RD	Y 11219
PASADENA (1995)	0406.403 1333.341	DPW BM TAG IN CONC BASE OF THE MIDDLE OF THREE 120MM GUARD POST 3M W/O C/L KINNELOA RANCH RD & 5.3M S/O C/L SIERRA MADRE VILLA DR	Y 11220
PASADENA (1995)	0309.822 1016.474	L&BR IN W CB 300MM S/O BCR @ SW COR KINNELOA CYN RD & OUTPOST LN 12M S & 6M W/O C/L INT	Y 11221
PASADENA (1995)	0278.387 0913.341	RDBM BRASS MON IN WELL @ C/L INT EATON CYN RD & NEW YORK DR MKD (1964)	Y 11222

JAD-YEAR	ELEV METER/FOOT	DESCRIPTION (INCLUDE QUAD AND YEAR IN DESCRIPTION)	BM NUMBER
PASADENA (1995)	0286.669 0940.513	PK NAIL IN N CB @ NE COR BRIDGE ABUT OVER EATON CYN WASH 12M NLY C/L NEW YORK DR & 322M ELY C/L ALTADENA DR	Y 11223
PASADENA (1995)	0289.241 0948.952	PK NAIL IN N CB @ NW COR BRIDGE ABUT OVER EATON CYN WASH 12M NLY C/L NEW YORK DR & 276M ELY OF C/L ALTADENA DR	Y 11224
LA CANADA (1995)	0336.385 1103.623	L&BR IN W CB 4.6M S/O BCR @ SW COR FOOTHILL BLVD & OAK GROVE DR 17M S & 10M W/O C/L INT	Y 11225
LA CANADA (1995)	0362.853 1190.460	CS BR CAP IN WALK 7M E/O BCR IN RET @ NW COR FOOTHILL BL & DALERIDGE DR 7M N & 13M W C/L INT	Y 11226
LA CANADA (1995)	0363.062 1191.146	L&T IN S CB FOOTHILL BLVD 7.6M S/O C/L & 18M W/O C/L PROD DALERIDGE DR	Y 11227
LA CANADA (1995)	0354.314 1162.445	DPW BM TAG IN W CB 1M S/O BCR @ SW COR FOOTHILL BLVD & GEORGIAN RD 18M S & 5M W/O C/L INT	Y 11228
CANADA (1995)	0390.695 1281.805	RAMSET & WASHER IN N <b>OUT</b> FOOTHILL BLVD 11M N/O C/L & 10M W/O C/L PROD BENJAM DR	Y 11229
LA CANADA (1995)	0456.001 1496.063	DPW BM TAG IN S CB RET 2M W BCR @ SE COR OCEAN VIEW BL & FOOTHILL BL 27M E & 13M S/O C/L INT	Y 11230
LA CANADA (1995)	0456.583 1497.973	L&T IN N CB 16M E/O BCR @ NE COR FOOTHILL BLVD & OCEAN VIEW BLVD 22M E & 13M N/O C/L INT	Y 11231
LA CANADA (1995)	0409.680 1344.092	L&T SLY CB @ END OF CONC 11M S/O C/L MONTROSE AVE & 21M E/O C/L ROSEMONT AVE	Y 11232
LA CANADA (1995)	0510.133 1673.661	DPW BM TAG IN E CB 1M S/O BCR 15.5M S/O C/L LOS OLIVOS LN & 6.4M E/O C/L PENNSYLVANIA AVE	Y 11233
LA CANADA (1995)	0512.409 1681.129	DPW BM TAG IN E CB 7M N/O BCR 21M N/O C/L LOS OLIVOS LN & 6.4M E/O C/L PENNSYLVANIA AVE IN C B	Y 11234
LA CANADA (1995)	0536.033 1758.635	CO ENG TAG IN W CB PENNSYLVANIA AVE 6.4M W/O C/L ON C/L PROD EL CAMINTO ST	Y 11235
LA CANADA (1995)	0589.298 1933.389	L&BR IN S CB RET 1.8M E/O BCR @ SW COR FRANCIS AVE & PENNSYLVANIA AVE 12M W & 4.6M S/O C/L INT	Y 11236
LA CANADA (1995)	0591.030 1939.071	L&SPK IN N CB 3M W/O BCR @ NW COR PENNSYLVANIA AVE & FRANCIS AVE 27M W & 4.6M N/O C/L INT	Y 11237
LA CANADA (1995)	0614.229 2015.183	L&BR IN E CB PENNSYLVANIA AVE 6.4M E/O C/L & 11M N/O C/L PROD RIMHILL RD	Y 11238



JAD-YEAR	ELEV METER/FOOT	DESCRIPTION (INCLUDE QUAD AND YEAR IN DESCRIPTION)	BM NUMBER
LA CANADA (1995)	0618.688 2029.812	FC BR CAP BM MON IN W CB PENNSYLVANIA AVE 6.4M W/O C/L & 13M S/O C/L PROD MARKRIDGE RD MKD (BM 40-271 1966)	Y 11239
LA CANADA (1995)	0559.759 1836.476	DPW BM TAG IN N CB 1M W/O BCR @ NW COR ORANGE AVE & PENNSYLVANIA AVE 18M W & 8M N/O C/L INT	Y 11240
LA CANADA (1995)	0560.929 1840.315	SPK&W IN SLY CB ORANGE AVE 21M E/O BCR 4M S/O C/L & 45M E/O C/L RAMSDELL AVE MKD (137)	Y 11241
LA CANADA (1995)	0547.971 1797.802	L&BR IN W CB RET 1.4M N/O BCR @ SW COR ORANGE AVE & ROSEMONT AVE 12M S & 6M W/O C/L INT	Y 11242
LA CANADA (1995)	0548.926 1800.935	L&BR IN S CB 175MM W/O BCR @ SE COR ORANGE AVE & ROSEMONT AVE 15M E & 4.6M S/O C/L INT	Y 11243
LA CANADA (1995)	0576.084 1890.036	CO ENG TAG IN E CB BRIGGS AVE 6M E/O C/L & 6M N/O C/L PROD WHITTIER DR	Y 11244
LA CANADA (1995)	0365.285 1198.439	L&FC TAG IN W CB @ BCR SW COR CASITAS AVE & HARRIET ST 14M S & 6M W/O C/L INT	Y 11245
LA CANADA (1995)	0410.273 1346.037	FC DISK IN E END CONC HDWL 5M S/O SLY CF 11M S/O C/L MONTROSE AVE & 36M W/O C/L ROSEMONT AVE MKD (BM 040-30420 1967)	Y 11246
LA CANADA (1995)	0433.166 1421.145	LA CITY BR DISK IN SE COR C B 1M W BCR @ NE COR OCEAN VIEW BLVD & LUANA LN 13M N & 11M E/O C/L INT MKD (PBM 09-00477 1987)	Y 11247
LA CANADA (1995)	0335.448 1100.549	DPW TAG W CB 300MM S/O BCR @ SW COR WINDSOR AVE & LA CANADA VERDUGO RD 19M S & 12M W/O C/L INT	Y 11248
LA CANADA (1995)	0336.223 1103.092	L&BR IN W CB 7M N/O BCR @ NW COR WINDSOR AVE & LA CANADA VERDUGO RD 18M N & 9M W/O C/L INT	Y 11249
LA CANADA (1995)	0348.185 1142.337	L&BR IN E CB WINDSOR AVE 14.6M E/O C/L & @ OR NR C/L PROD KENT ST	Y 11250
LA CANADA (1995)	0348.140 1142.189	LA CO DPW TAG IN N CB KENT ST 400MM W/O BCR 6M N/O C/L & 22M W/O C/L WINDSOR AVE	Y 11251
LA CANADA (1995)	0336.310 1103.377	L&BR IN S CB HIGHLAND DR 8M S/O C/L ON C/L PROD (210) FRWY OVERPASS	Y 11252
LA CANADA (1995)	0360.772 1183.633	DPW BM TAG IN ELY CB OF ISLAND 300MM S/O BCR 6M S/O C/L HIGHLAND DR & 6M E/O C/L CORONA DR	Y 11253
LA CANADA (1995)	0368.141 1207.809	DPW BM TAG IN S CB BERKSHIRE AVE 1M E/O BCR 4M S/O C/L & 25M E/O C/L CHEVY CHASE DR	Y 11254

QUAD-YEAR	ELEV METER/FOOT	DESCRIPTION (INCLUDE QUAD AND YEAR IN DESCRIPTION)	BM NUMBER
LA CANADA (1995)	0369.645 1212.744	DPW BM TAG IN W CB CHEVY CHASE DR 4M W/O C/L & 4M N/O C/L PROD BERKSHIRE AVE	Y 11255
LA CANADA (1995)	0367.095 1204.378	L&BR IN W CB CHEVY CHASE DR S END C B 5M W/O C/L & 26M N/O C/L DESCANSO DR (TO THE W)	Y 11256
LA CANADA (1995)	0357.112 1171.625	CS BR DISK IN CONC PAD 1M N/O GUARD RAIL 7M N C/L HIGHLAND DR & 4.3M W/O PP #228843E 360M W/O BERKSHIRE AVE E MKD (TRAV STA ALTADENA B-2 1966)	Y 11257